

ON HOLD PENDING FINAL SOLUTION AND APPROVAL IN COORDINATION WITH COUNCIL

MC90 - 'ALOYSIUS STREET'

DRAINAGE RESERVE

EXISTING SEWER MAIN TO BE REMOVED. REFER SA WATER PLANS

4.00m EXISTING SEWER EASEMENT TO BE EXTINGUISHED

4.00m EXISTING SEWER EASEMENT TO BE EXTINGUISHED. REFER SA WATER PLANS

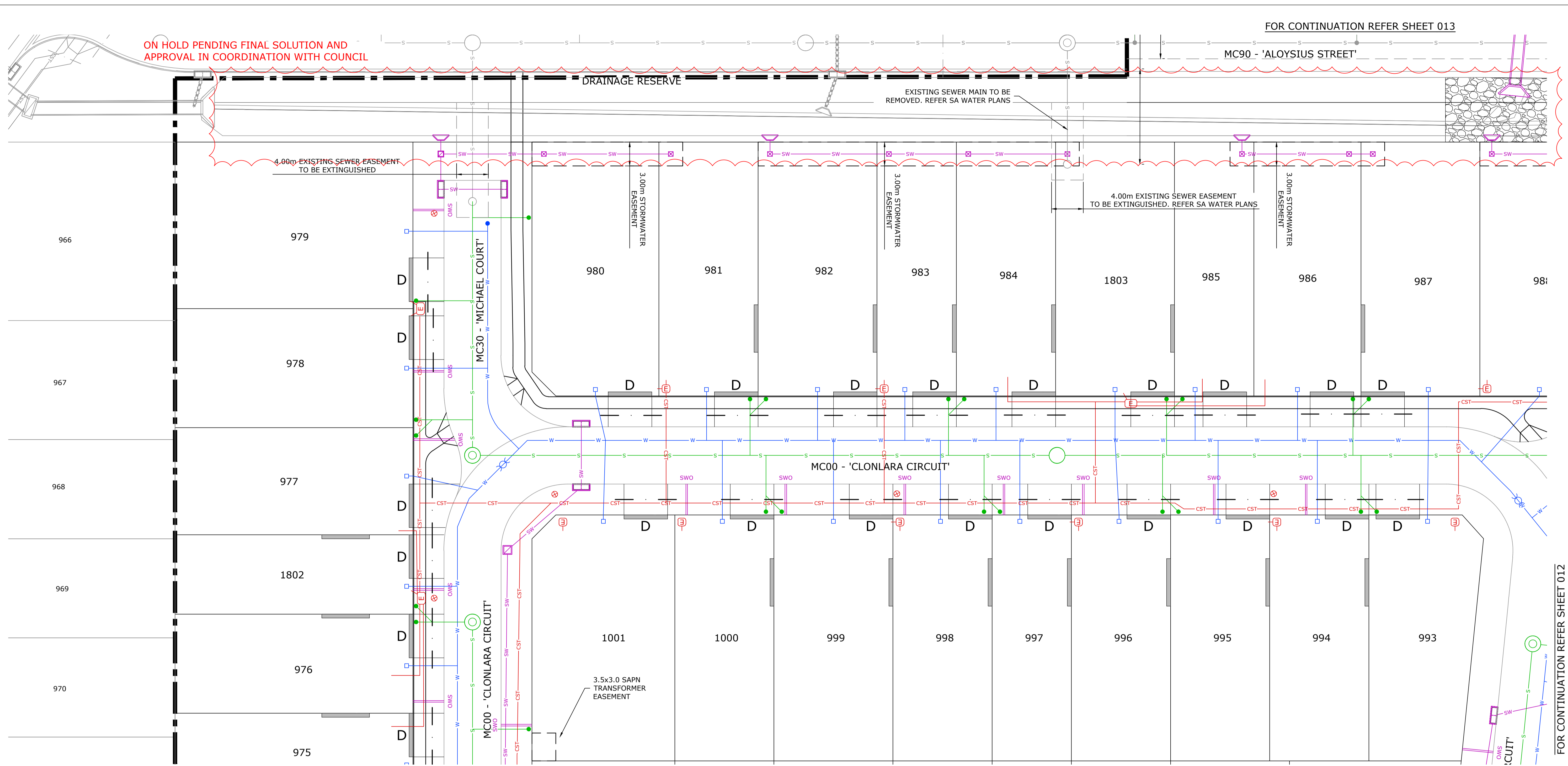

FOR CONTINUATION REFER SHEET 011

FOR CONTINUATION REFER SHEET 012

LEGEND:

- PROPOSED STAGE BOUNDARY
- PROPOSED WATER MAIN (REFER SA WATER DRAWINGS)
- PROPOSED CST (REFER SAPN DRAWINGS)
- PROPOSED SEWER MAIN (REFER SA WATER DRAWINGS)
- PROPOSED STORMWATER DRAIN (REFER SHEETS 070 TO 073)
- PROPOSED WATER CONNECTION (REFER SA WATER DRAWINGS)
- PROPOSED POTABLE WATER FITTINGS (REFER SA WATER DRAWINGS)
- PROPOSED SAPN PILLAR/UNDERGROUND PIT (REFER SAPN DRAWINGS)
- PROPOSED SAPN LIGHT POLE (REFER SAPN DRAWINGS)
- PROPOSED SEWER MAN HOLE (REFER SA WATER DRAWINGS)
- PROPOSED MAINTENANCE SHAFT (REFER SA WATER DRAWINGS)
- PROPOSED SEWER I.O. (REFER SA WATER DRAWINGS)
- PROPOSED SEWER CONNECTION (REFER SA WATER DRAWINGS)
- PROPOSED STORM WATER KERB OUTLET
- PROPOSED SIDE ENTRY PIT (SEP) (REFER SHEETS 070 TO 073)
- PROPOSED JUNCTION BOX (JB) (REFER SHEETS 070 TO 073)
- PROPOSED HEADWALL (HW) (REFER SHEETS 070 TO 073)
- PROPOSED FOOTPATH
- DENOTES FUTURE DRIVEWAY LOCATION (BY OTHERS)
- DENOTES ALLOWABLE BOUNDARY BUILD (BY FUTURE OWNER) (REFER SHEETS 070 TO 073)
- PROPOSED Ø100mm IRRIGATION CONDUIT. REFER GENERAL CONSTRUCTION DRAWINGS FOR IRRIGATION NOTES
- EXISTING WATER MAIN
- EXISTING CST
- EXISTING SEWER MAIN
- EXISTING STORMWATER DRAIN

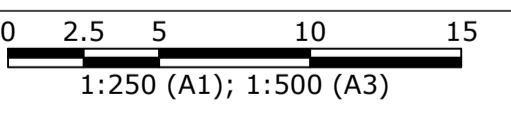

SHEET SIZE A1

100mm ON ORIGINAL DRAWING - DO NOT SCALE DRAWING

COORDS: MGA94 ZONE 54
 DATUM: ALL LEVELS TO A.H.D.
 SCALE: 1:250
 SURVEYED: ALEXANDER SYMONDS
 SURVEY DATE: 19.10.2020
 APPROVED / PROJECT LEADER

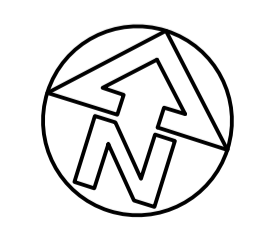

PUBLIC UTILITIES:
 THE SERVICES SHOWN ARE DERIVED FROM PLANS OBTAINED FROM THE RELEVANT SERVICE AUTHORITIES. IT IS THE RESPONSIBILITY OF THE CONTRACTOR TO ARRANGE WITH THE RELEVANT SERVICE AUTHORITIES FOR CONFIRMATION OF SERVICES AND THEIR LOCATION BEFORE EXCAVATION WORK COMMENCES.

THIS DRAWING IS TO BE VIEWED IN COLOUR AS SOME FEATURES / SYMBOLS ARE DIFFERENTIATED BY COLOUR. DRAWING NOT TO BE RELIED ON IF PRINTED IN GREYSCALE.

FOR CONSTRUCTION



tonkin.com.au

ASTRAD PTY LTD
 VIRGINIA GROVE - STAGE 18
 D/N: 292/D003/20 - SHEEDY ROAD VIRGINIA
 MASTER SERVICES PLAN - SHEET 1

FILENAME:	PROJECT NUMBER	DRAWING NUMBER	REVISION
220419_03_SERVICES.DWG	220419	010	0

FOR CONTINUATION REFER SHEET 010

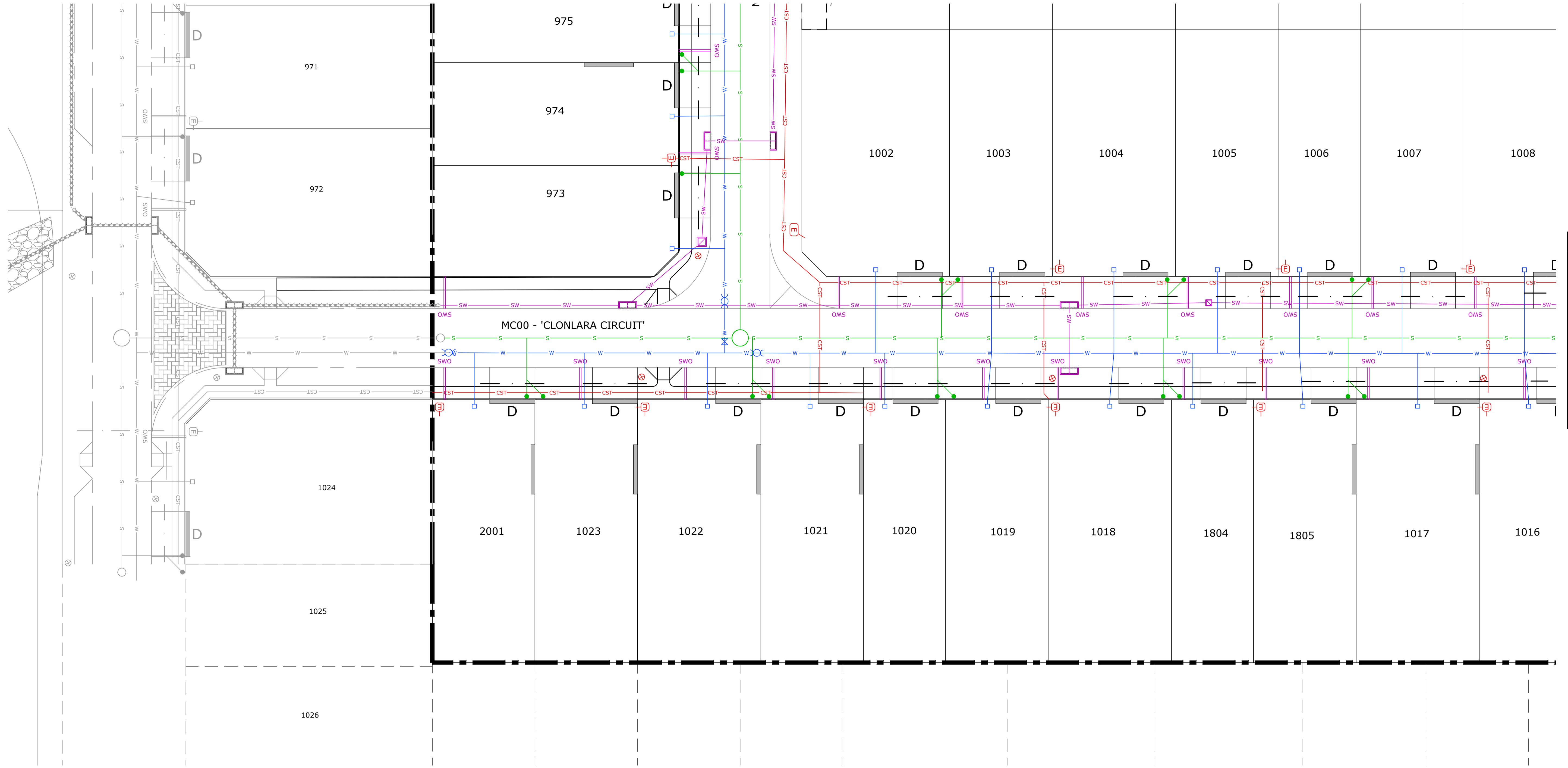

FOR CONTINUATION REFER SHEET 012

LEGEND:

- PROPOSED STAGE BOUNDARY
- PROPOSED WATER MAIN (REFER SA WATER DRAWINGS)
- PROPOSED CST (REFER SAPN DRAWINGS)
- PROPOSED SEWER MAIN (REFER SA WATER DRAWINGS)
- PROPOSED STORMWATER DRAIN (REFER SHEETS 070 TO 073)
- PROPOSED WATER CONNECTION (REFER SA WATER DRAWINGS)
- PROPOSED POTABLE WATER FITTINGS (REFER SA WATER DRAWINGS)

- PROPOSED SAPN PILLAR/UNDERGROUND PIT (REFER SAPN DRAWINGS)
- PROPOSED SAPN LIGHT POLE (REFER SAPN DRAWINGS)
- PROPOSED SEWER MAN HOLE (REFER SA WATER DRAWINGS)
- PROPOSED MAINTENANCE SHAFT (REFER SA WATER DRAWINGS)
- PROPOSED SEWER I.O. (REFER SA WATER DRAWINGS)
- PROPOSED SEWER CONNECTION (REFER SA WATER DRAWINGS)

- PROPOSED STORM WATER KERB OUTLET
- PROPOSED SIDE ENTRY PIT (SEP) (REFER SHEETS 070 TO 073)
- PROPOSED JUNCTION BOX (JB) (REFER SHEETS 070 TO 073)
- PROPOSED HEADWALL (HW) (REFER SHEETS 070 TO 073)
- PROPOSED FOOTPATH

- DENOTES FUTURE DRIVEWAY LOCATION (BY OTHERS)
- DENOTES ALLOWABLE BOUNDARY BUILD (BY FUTURE OWNER)
- PROPOSED Ø100mm IRRIGATION CONDUIT. REFER GENERAL CONSTRUCTION DRAWINGS FOR IRRIGATION NOTES
- EXISTING WATER MAIN
- EXISTING CST
- EXISTING SEWER MAIN
- EXISTING STORMWATER DRAIN

0 2.5 5 10 15
1:250 (A1); 1:500 (A3)

100mm ON ORIGINAL DRAWING - DO NOT SCALE DRAWING

SHEET SIZE
A1

COORDS: MGA94 ZONE 54
DATUM: ALL LEVELS TO A.H.D.
SCALE: 1:250
SURVEYED: ALEXANDER SYMONDS
SURVEY DATE: 19.10.2020
APPROVED / PROJECT LEADER

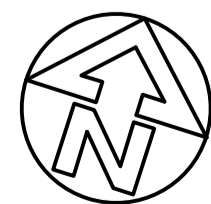

PUBLIC UTILITIES:

THE SERVICES SHOWN ARE DERIVED FROM PLANS OBTAINED FROM THE RELEVANT SERVICE AUTHORITIES. IT IS THE RESPONSIBILITY OF THE CONTRACTOR TO ARRANGE WITH THE RELEVANT SERVICE AUTHORITIES FOR CONFIRMATION OF SERVICES AND THEIR LOCATION BEFORE EXCAVATION WORK COMMENCES.

THIS DRAWING IS TO BE VIEWED IN COLOUR AS SOME FEATURES / SYMBOLS ARE DIFFERENTIATED BY COLOUR. DRAWING NOT TO BE RELIED ON IF PRINTED IN GREYSCALE.

FOR CONSTRUCTION



tonkin.com.au

ASTRAD PTY LTD

VIRGINIA GROVE - STAGE 18
D/N: 292/D003/20 - SHEEDY ROAD VIRGINIA
MASTER SERVICES PLAN - SHEET 2

FILENAME: 220419_03_SERVICES.DWG	PROJECT NUMBER 220419	DRAWING NUMBER 011	REVISION 0
-------------------------------------	--------------------------	-----------------------	---------------

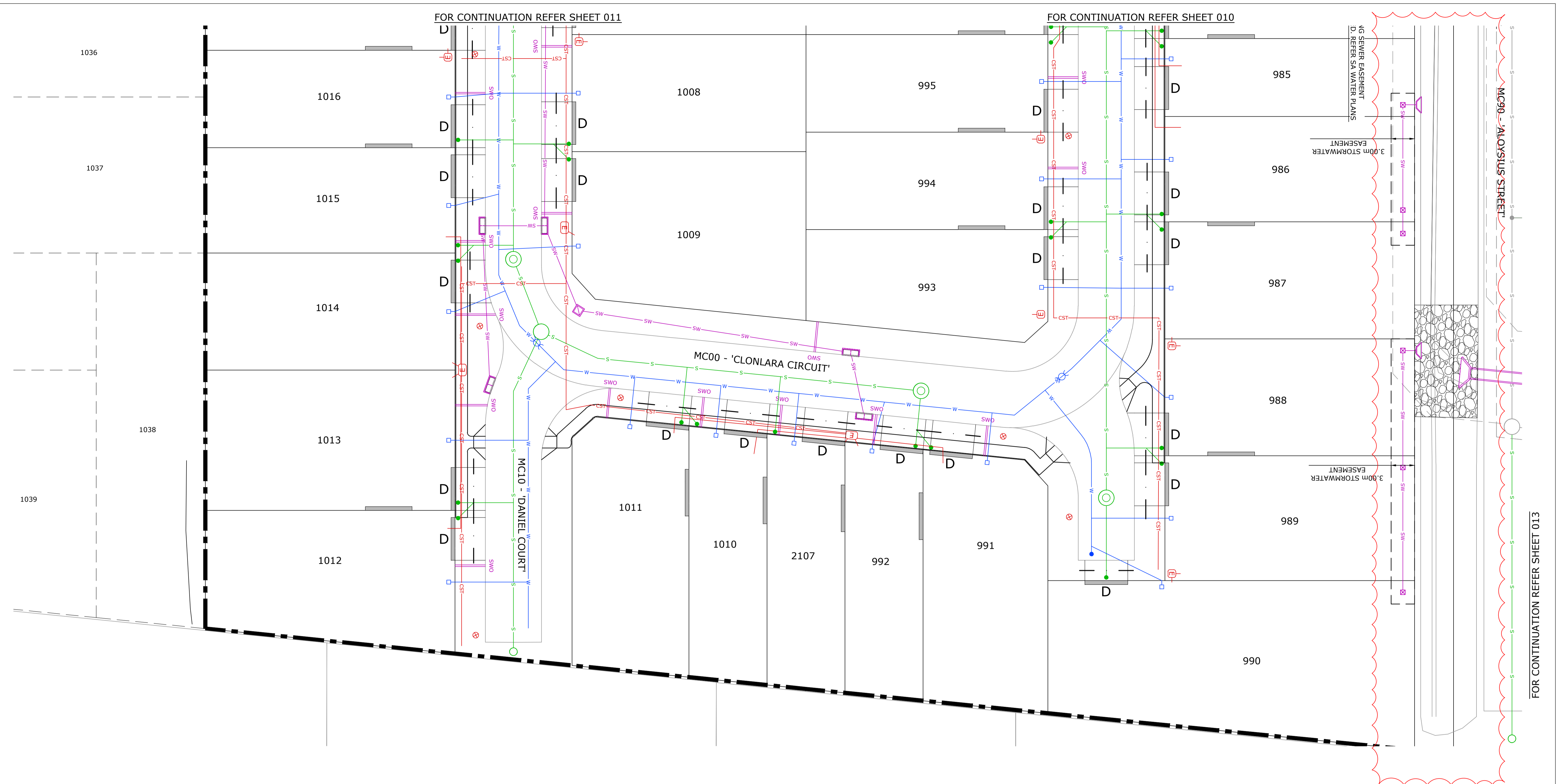

- LEGEND:**
- PROPOSED STAGE BOUNDARY
 - PROPOSED WATER MAIN (REFER SA WATER DRAWINGS)
 - PROPOSED CST (REFER SAPN DRAWINGS)
 - PROPOSED SEWER MAIN (REFER SA WATER DRAWINGS)
 - PROPOSED STORMWATER DRAIN (REFER SHEETS 070 TO 073)
 - PROPOSED WATER CONNECTION (REFER SA WATER DRAWINGS)
 - PROPOSED POTABLE WATER FITTINGS (REFER SA WATER DRAWINGS)

- PROPOSED SAPN PILLAR/UNDERGROUND PIT (REFER SAPN DRAWINGS)
- PROPOSED SAPN LIGHT POLE (REFER SAPN DRAWINGS)
- PROPOSED SEWER MAN HOLE (REFER SA WATER DRAWINGS)
- PROPOSED MAINTENANCE SHAFT (REFER SA WATER DRAWINGS)
- PROPOSED SEWER I.O. (REFER SA WATER DRAWINGS)
- PROPOSED SEWER CONNECTION (REFER SA WATER DRAWINGS)

- PROPOSED STORM WATER KERB OUTLET
- PROPOSED SIDE ENTRY PIT (SEP) (REFER SHEETS 070 TO 073)
- PROPOSED JUNCTION BOX (JB) (REFER SHEETS 070 TO 073)
- PROPOSED HEADWALL (HW) (REFER SHEETS 070 TO 073)
- PROPOSED FOOTPATH

- DENOTES FUTURE DRIVEWAY LOCATION (BY OTHERS)
- DENOTES ALLOWABLE BOUNDARY BUILD (BY FUTURE OWNER)
- PROPOSED Ø100mm IRRIGATION CONDUIT. REFER GENERAL CONSTRUCTION DRAWINGS FOR IRRIGATION NOTES
- EXISTING WATER MAIN
- EXISTING CST
- EXISTING SEWER MAIN
- EXISTING STORMWATER DRAIN

ON HOLD PENDING FINAL SOLUTION AND APPROVAL IN COORDINATION WITH COUNCIL

THIS DRAWING IS TO BE VIEWED IN COLOUR AS SOME FEATURES / SYMBOLS ARE DIFFERENTIATED BY COLOUR. DRAWING NOT TO BE RELIED ON IF PRINTED IN GREYSKALE.

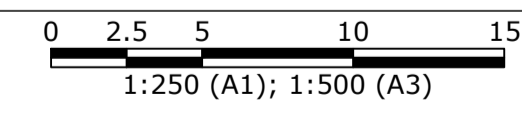

SHEET SIZE
A1

COORDS: MGA94 ZONE 54
DATUM: ALL LEVELS TO A.H.D.
SCALE: 1:250
SURVEYED: ALEXANDER SYMONDS
SURVEY DATE: 19.10.2020
APPROVED / PROJECT LEADER

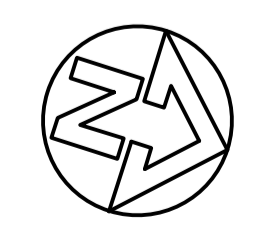

PUBLIC UTILITIES:
THE SERVICES SHOWN ARE DERIVED FROM PLANS OBTAINED FROM THE RELEVANT SERVICE AUTHORITIES. IT IS THE RESPONSIBILITY OF THE CONTRACTOR TO ARRANGE WITH THE RELEVANT SERVICE AUTHORITIES FOR CONFIRMATION OF SERVICES AND THEIR LOCATION BEFORE EXCAVATION WORK COMMENCES.



FOR CONSTRUCTION
ASTRAD PTY LTD
VIRGINIA GROVE - STAGE 18
D/N: 292/D003/20 - SHEEDY ROAD VIRGINIA
MASTER SERVICES PLAN - SHEET 3

REV	ISSUED FOR CONSTRUCTION	DATE	DES.	DWN.	AMENDMENT / REASON FOR ISSUE
0	ISSUED FOR CONSTRUCTION	20.03.23	RIH	RIH	

FILENAME:	PROJECT NUMBER	DRAWING NUMBER	REVISION
220419_03_SERVICES.DWG	220419	012	0

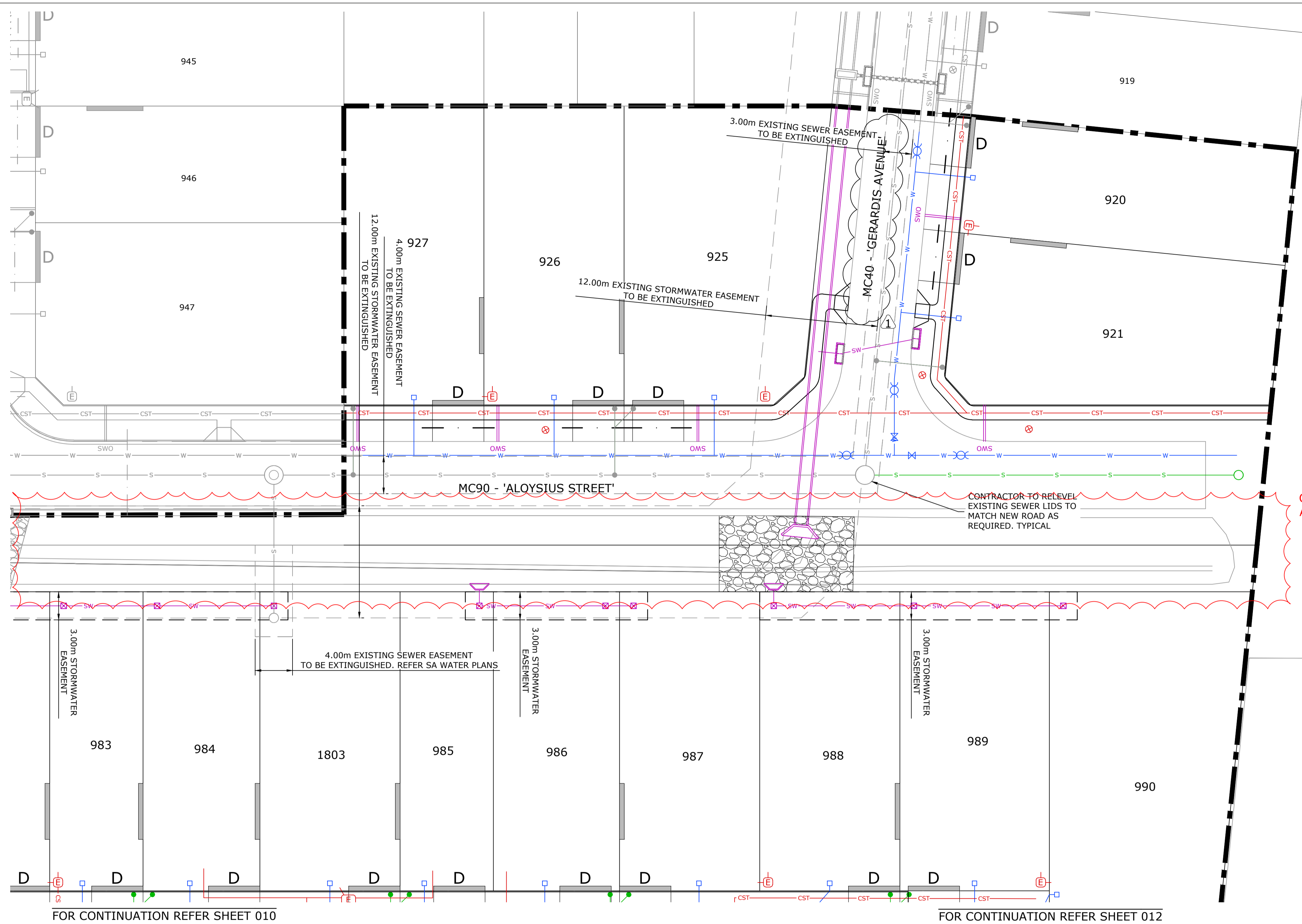

ON HOLD PENDING FINAL SOLUTION AND APPROVAL IN COORDINATION WITH COUNCIL

LEGEND:

- PROPOSED STAGE BOUNDARY
- PROPOSED WATER MAIN (REFER SA WATER DRAWINGS)
- PROPOSED CST (REFER SAPN DRAWINGS)
- PROPOSED SEWER MAIN (REFER SA WATER DRAWINGS)
- PROPOSED STORMWATER DRAIN (REFER SHEETS 070 TO 073)
- PROPOSED WATER CONNECTION (REFER SA WATER DRAWINGS)
- PROPOSED POTABLE WATER FITTINGS (REFER SA WATER DRAWINGS)
- PROPOSED SAPN PILLAR/UNDERGROUND PIT (REFER SAPN DRAWINGS)
- PROPOSED SAPN LIGHT POLE (REFER SAPN DRAWINGS)
- PROPOSED SEWER MAN HOLE (REFER SA WATER DRAWINGS)
- PROPOSED MAINTENANCE SHAFT (REFER SA WATER DRAWINGS)
- PROPOSED SEWER I.O. (REFER SA WATER DRAWINGS)
- PROPOSED SEWER CONNECTION (REFER SA WATER DRAWINGS)
- PROPOSED STORM WATER KERB OUTLET
- PROPOSED SIDE ENTRY PIT (SEP) (REFER SHEETS 070 TO 073)
- PROPOSED JUNCTION BOX (JB) (REFER SHEETS 070 TO 073)
- PROPOSED HEADWALL (HW) (REFER SHEETS 070 TO 073)
- PROPOSED FOOTPATH
- DENOTES FUTURE DRIVEWAY LOCATION (BY OTHERS)
- DENOTES ALLOWABLE BOUNDARY BUILD (BY FUTURE OWNER)
- PROPOSED Ø100mm IRRIGATION CONDUIT. REFER GENERAL CONSTRUCTION DRAWINGS FOR IRRIGATION NOTES
- EXISTING WATER MAIN
- EXISTING CST
- EXISTING SEWER MAIN
- EXISTING STORMWATER DRAIN

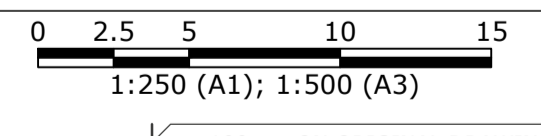

SHEET SIZE
A1

COORDS: MGA94 ZONE 54			
DATUM: ALL LEVELS TO A.H.D.			
SCALE: 1:250			
SURVEYED: ALEXANDER SYMONDS			
SURVEY DATE: 19.10.2020			
APPROVED / PROJECT LEADER			
S.CONDINA			
1	STREET NAME CHANGE - LEO AVENUE TO GERARDIS AVENUE	18.07.23	IH IH
0	ISSUED FOR CONSTRUCTION	20.03.23	RIH RIH
REV	AMENDMENT / REASON FOR ISSUE	DATE	DES. DWN.

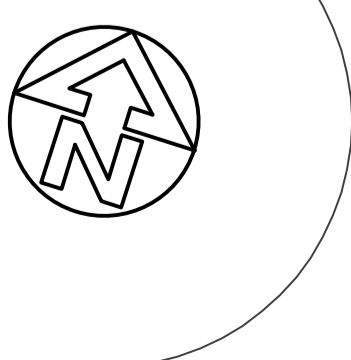

PUBLIC UTILITIES:
THE SERVICES SHOWN ARE DERIVED FROM PLANS OBTAINED FROM THE RELEVANT SERVICE AUTHORITIES. IT IS THE RESPONSIBILITY OF THE CONTRACTOR TO ARRANGE WITH THE RELEVANT SERVICE AUTHORITIES FOR CONFIRMATION OF SERVICES AND THEIR LOCATION BEFORE EXCAVATION WORK COMMENCES.

THIS DRAWING IS TO BE VIEWED IN COLOUR AS SOME FEATURES / SYMBOLS ARE DIFFERENTIATED BY COLOUR. DRAWING NOT TO BE RELIED ON IF PRINTED IN GREYSCALE.



FOR CONSTRUCTION
ASTRAD PTY LTD
VIRGINIA GROVE - STAGE 18
D/N: 292/D003/20 - SHEEDY ROAD VIRGINIA
MASTER SERVICES PLAN - SHEET 4

FILENAME:	PROJECT NUMBER	DRAWING NUMBER	REVISION
220419_03_SERVICES.DWG	220419	013	1

ON HOLD PENDING FINAL SOLUTION AND APPROVAL IN COORDINATION WITH COUNCIL

MATCH INTO INVERT OF EXISTING SWALE. EXISTING 1 IN 5 BATTERS ON SOUTHERN SIDE OF SWALE TO BE RECONSTRUCTED TO FINAL 1 IN 3 BATTERS WITH GABION RETAINING WALL (BY OTHERS) AS PER DETAIL ON SHEET 076

FOR CONTINUATION REFER SHEET 023

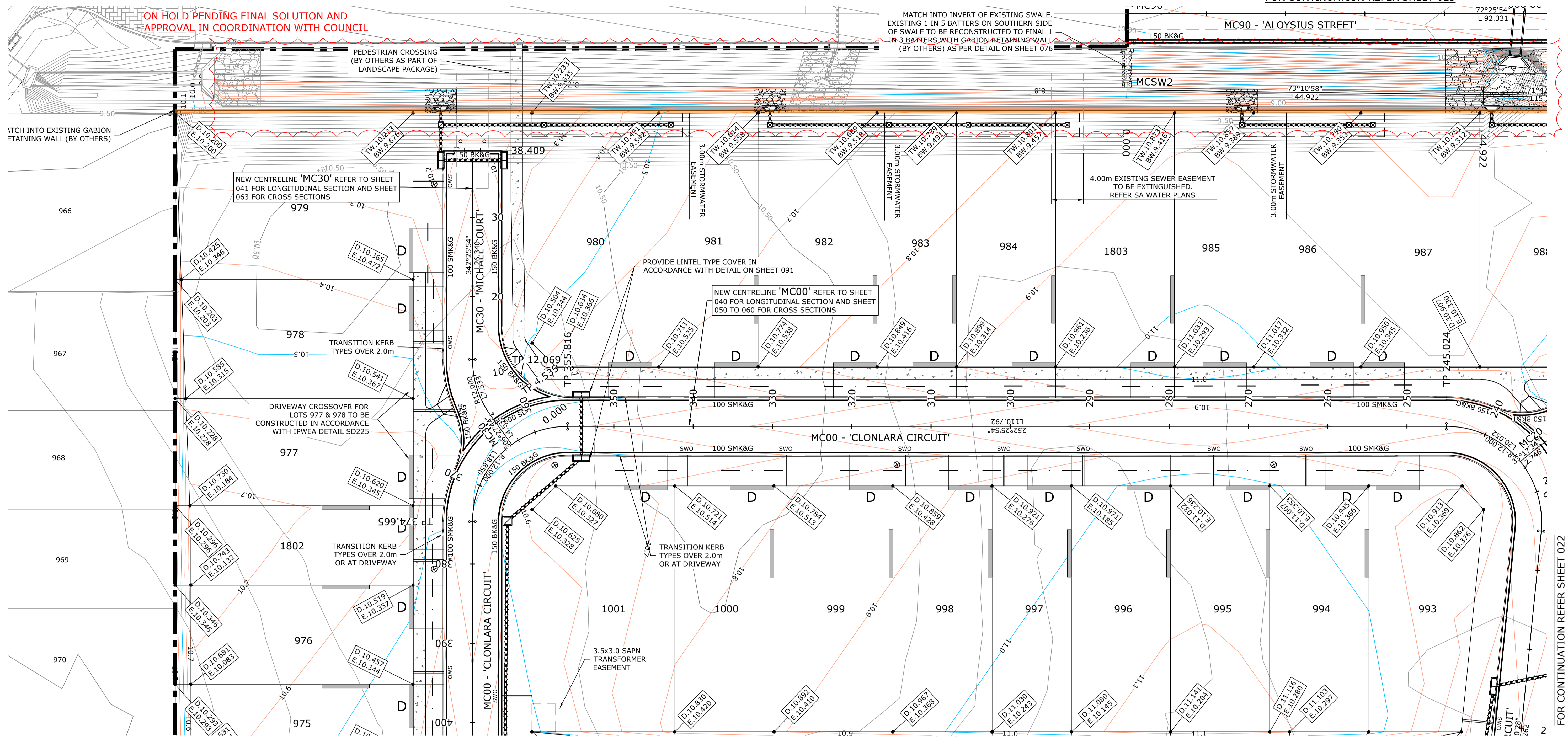

NEW CENTRELINE 'MC30' REFER TO SHEET 041 FOR LONGITUDINAL SECTION AND SHEET 063 FOR CROSS SECTIONS

NEW CENTRELINE 'MC00' REFER TO SHEET 040 FOR LONGITUDINAL SECTION AND SHEET 050 TO 060 FOR CROSS SECTIONS

PROVIDE LINTEL TYPE COVER IN ACCORDANCE WITH DETAIL ON SHEET 091

DRIVEWAY CROSSOVER FOR LOTS 977 & 978 TO BE CONSTRUCTED IN ACCORDANCE WITH IPWEA DETAIL SD225

3.5x3.0 SAPN TRANSFORMER EASEMENT

NOTES:

- FOR EACH LOT WHERE THE FOOTPATH IS ADJACENT THE LOT BOUNDARY, A 100mm PVC IRRIGATION CONDUIT SHOULD BE PROVIDED IN ADDITION TO THE 100mm PVC STORMWATER KERB OUTLET. THE IRRIGATION CONDUIT SHOULD EXTEND 300mm EACH SIDE OF THE FOOTPATH AND BE CAPPED AT EACH END. PLACE CONDUIT 1m OFFSET FROM WATER METER. IF WATER METER IS ADJACENT DRIVEWAY, PLACE CONDUIT 1m OFFSET FROM DRIVEWAY EDGE (CONFIRM ON SITE).
- FOR ALL IRRIGATION CONDUITS CROSSING ROADS, PROVIDE 2 x Ø100mm PVC PIPE, EXTENDING 1m PAST THE BACK OF KERB ON BOTH SIDES, CAP EACH END AND PROVIDE DRAWCORDS TO THE SURFACE.
- PROVIDE Ø100mm PVC IRRIGATION CONDUITS UNDER FUTURE DRIVEWAY LOCATIONS WHERE SHOWN EXTENDING 300mm EACH SIDE OF FUTURE DRIVEWAY, CAP EACH END.
- PROVIDE 150 HIGH BARRIER KERB AND GUTTER ON ALL KERB RETURNS AT INTERSECTIONS AND EXTEND MINIMUM 6.0m PAST TANGENT POINTS.
- TRAFFIC CONTROL DETAILS AND RETROREFLECTIVE RAISED PAVEMENT MARKERS INSTALLED IN ACCORDANCE WITH AUSTRALIAN STANDARD 'AS 1742 MANUAL OF TRAFFIC CONTROL DEVICES' AS MODIFIED BY DIT'S CODE OF TECHNICAL REQUIREMENTS, AND THE DIT 'PAVEMENT MARKING MANUAL'.
- REFER TO SHEETS 080 TO 083 FOR STREET SIGN LOCATIONS. FOR SIGN INSTALLATION DETAILS REFER TO 'DIT MASTER SPECIFICATION, PART RD-LM-C4 SIGN INSTALLATION' & CITY OF PLAYFORD REQUIREMENTS.
- ANY BATTERS REQUIRED DURING CONSTRUCTION TO BE GRADED BACK TO EXISTING AT 1 IN 5 MAXIMUM.
- ALL EARTHWORKS FILL WITHIN ALLOTMENTS TO BE TO LEVEL 1 AS PER SPECIFICATION REQUIREMENTS

THIS DRAWING IS TO BE VIEWED IN COLOUR AS SOME FEATURES / SYMBOLS ARE DIFFERENTIATED BY COLOUR. DRAWING NOT TO BE RELIED ON IF PRINTED IN GREYSCALE.

LEGEND:

- 150 BK&G 150 HIGH BARRIER KERB & GUTTER (REFER SHEET 091 FOR DETAILS)
- 150 BK&T 150 BARRIER KERB & TRAY (REFER SHEET 091 FOR DETAILS)
- 100 SMK&G 100 HIGH SEMI-MOUNTABLE KERB & GUTTER (REFER SHEET 091 FOR DETAILS)
- 100 SMK&T 100 HIGH SEMI-MOUNTABLE KERB & TRAY (REFER SHEET 091 FOR DETAILS)
- 600 SD 600 WIDE SPOON DRAIN (REFER SHEET 091 FOR DETAILS)
- CEB 190 WIDE CONCEALED EDGE BEAM (REFER SHEET 091 FOR DETAILS)
- D.XX.XX DESIGN SURFACE LEVEL
- E.XX.XX EXISTING SURFACE LEVEL
- TW.XX.XX TOP OF RETAINING WALL
- BW.XX.XX BOTTOM OF RETAINING WALL
- CONCRETE KERB RAMP (REFER IPWEA DETAIL SD125 & SD130)
- PROPOSED SIDE ENTRY PIT (SEP) (REFER SHEETS 070 TO 073)
- PROPOSED JUNCTION BOX (JB) (REFER SHEETS 070 TO 073)
- PROPOSED GRATED INLET PIT (GIP) (REFER SHEETS 070 TO 073)
- PROPOSED HEADWALL (HW) (REFER SHEETS 070 TO 073)
- PROPOSED STORM WATER KERB OUTLET (REFER SHEET 091 FOR DETAILS)
- PROPOSED LIGHT POLE (REFER SAPN DRAWINGS)
- D DENOTES FUTURE DRIVEWAY LOCATION (BY OTHERS)
- DENOTES ALLOWABLE BOUNDARY BUILD (BY FUTURE OWNER)
- EXISTING STORMWATER DRAIN
- PROPOSED STORMWATER DRAIN (REFER SHEETS 070 TO 073)
- NEW ROAD PAVEMENT (REFER SHEET 084 FOR DETAILS)
- BLOCK PAVED THRESHOLD (REFER SHEET 084 FOR DETAILS)
- NEW 1.5m WIDE FOOTPATH (REFER SHEET 084 FOR DETAILS)
- FINISHED SURFACE MINOR CONTOURS (0.1m INTERVAL)
- FINISHED SURFACE MAJOR CONTOURS (0.5m INTERVAL)
- EXISTING SURFACE MINOR CONTOURS (0.1m INTERVAL)
- EXISTING SURFACE MAJOR CONTOURS (0.5m INTERVAL)
- PROPOSED STAGE BOUNDARY
- PROPOSED Ø100mm IRRIGATION CONDUIT. REFER TO NOTES
- PROPOSED CONCRETE SLEEPER RETAINING WALL. REFER SHEET 092 FOR DETAILS
- PROPOSED GABION WALL (BY OTHERS)

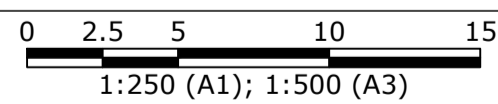

SHEET SIZE
A1

COORDS: MGA94 ZONE 54
DATUM: ALL LEVELS TO A.H.D.
SCALE: 1:250
SURVEYED: ALEXANDER SYMONDS
SURVEY DATE: 19.10.2020
APPROVED / PROJECT LEADER
S.CONDINA

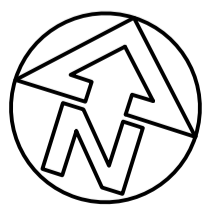

PUBLIC UTILITIES:
THE SERVICES SHOWN ARE DERIVED FROM PLANS OBTAINED FROM THE RELEVANT SERVICE AUTHORITIES. IT IS THE RESPONSIBILITY OF THE CONTRACTOR TO ARRANGE WITH THE RELEVANT SERVICE AUTHORITIES FOR CONFIRMATION OF SERVICES AND THEIR LOCATION BEFORE EXCAVATION WORK COMMENCES.



FOR CONSTRUCTION
ASTRAD PTY LTD
VIRGINIA GROVE - STAGE 18
D/N: 292/D003/20 - SHEEDY ROAD VIRGINIA
GENERAL CONSTRUCTION PLAN - SHEET 1

FILENAME:	PROJECT NUMBER	DRAWING NUMBER	REVISION
220419_04_GENERAL_CONSTRUCTION.DWG	220419	020	1

FOR CONTINUATION REFER SHEET 020

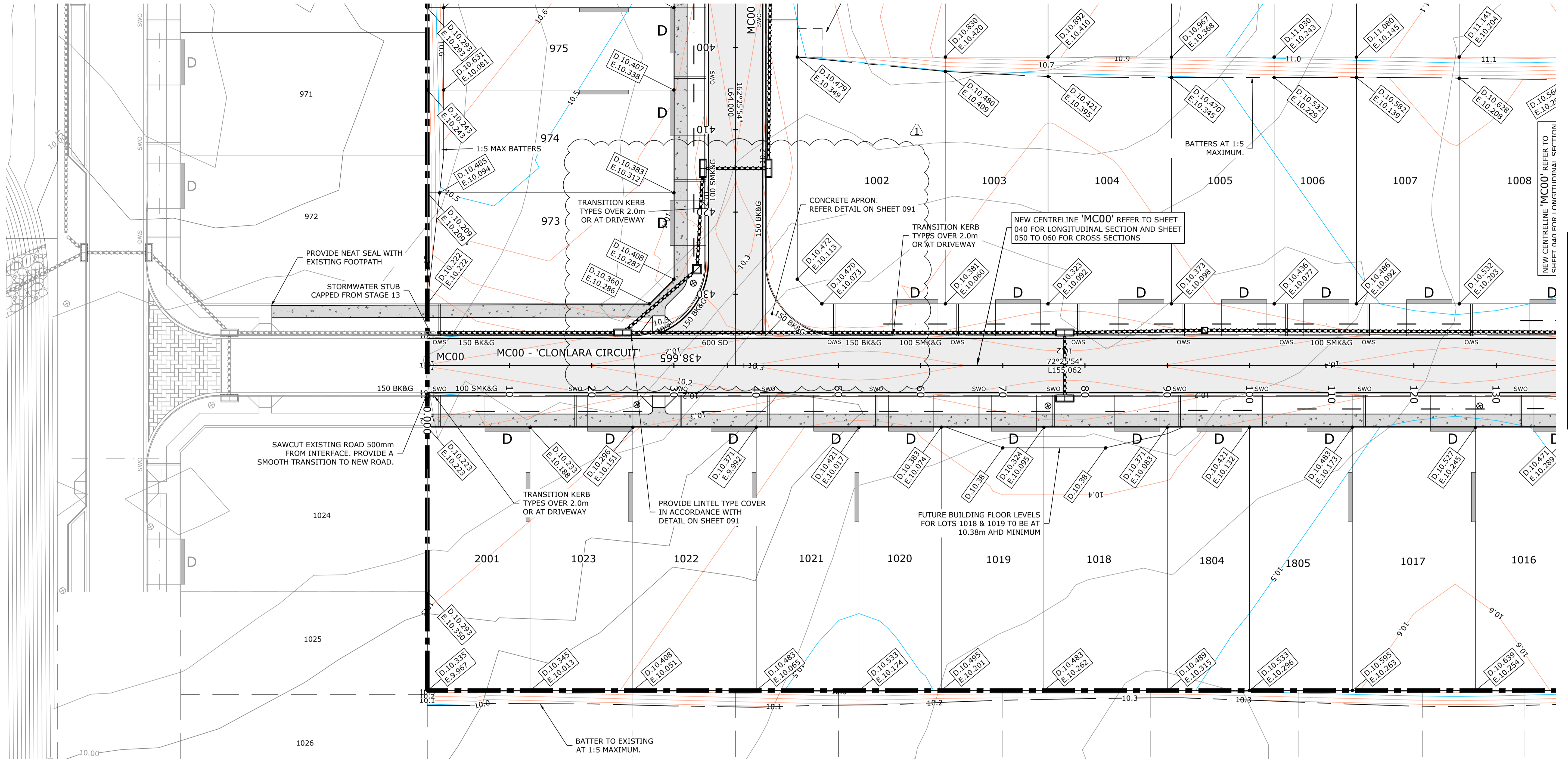

FOR CONTINUATION REFER SHEET 022

LEGEND:

- 150 BK&G** 150 HIGH BARRIER KERB & GUTTER (REFER SHEET 091 FOR DETAILS)
 - 150 BK&T** 150 BARRIER KERB & TRAY (REFER SHEET 091 FOR DETAILS)
 - 100 SMK&G** 100 HIGH SEMI-MOUNTABLE KERB & GUTTER (REFER SHEET 091 FOR DETAILS)
 - 100 SMK&T** 100 HIGH SEMI-MOUNTABLE KERB & TRAY (REFER SHEET 091 FOR DETAILS)
 - 600 SD** 600 WIDE SPOON DRAIN (REFER SHEET 091 FOR DETAILS)
 - CEB** 190 WIDE CONCEALED EDGE BEAM (REFER SHEET 091 FOR DETAILS)
 - D.XX.XX** DESIGN SURFACE LEVEL
 - E.XX.XX** EXISTING SURFACE LEVEL
 - TW.XX.XX** TOP OF RETAINING WALL
 - BW.XX.XX** BOTTOM OF RETAINING WALL
-
- CONCRETE KERB RAMP (REFER IPWEA DETAIL SD125 & SD130)
 - PROPOSED SIDE ENTRY PIT (SEP) (REFER SHEETS 070 TO 073)
 - PROPOSED JUNCTION BOX (JB) (REFER SHEETS 070 TO 073)
 - PROPOSED GRATED INLET PIT (GIP) (REFER SHEETS 070 TO 073)
 - PROPOSED HEADWALL (HW) (REFER SHEETS 070 TO 073)
 - PROPOSED STORM WATER KERB OUTLET (REFER SHEET 091 FOR DETAILS)
 - PROPOSED LIGHT POLE (REFER SAPN DRAWINGS)
-
- D** DENOTES FUTURE DRIVEWAY LOCATION (BY OTHERS)
 - DENOTES ALLOWABLE BOUNDARY BUILD (BY FUTURE OWNER)
 - EXISTING STORMWATER DRAIN
 - PROPOSED STORMWATER DRAIN (REFER SHEETS 070 TO 073)
 - NEW ROAD PAVEMENT (REFER SHEET 084 FOR DETAILS)
 - BLOCK PAVED THRESHOLD (REFER SHEET 084 FOR DETAILS)
 - NEW 1.5m WIDE FOOTPATH (REFER SHEET 084 FOR DETAILS)
-
- FINISHED SURFACE MINOR CONTOURS (0.1m INTERVAL)
 - FINISHED SURFACE MAJOR CONTOURS (0.5m INTERVAL)
 - EXISTING SURFACE MINOR CONTOURS (0.1m INTERVAL)
 - EXISTING SURFACE MAJOR CONTOURS (0.5m INTERVAL)
 - PROPOSED STAGE BOUNDARY
 - PROPOSED 100mm IRRIGATION CONDUIT. REFER TO NOTES
 - PROPOSED CONCRETE SLEEPER RETAINING WALL. REFER SHEET 092 FOR DETAILS
 - PROPOSED GABION WALL (BY OTHERS)

NOTES:

1. FOR EACH LOT WHERE THE FOOTPATH IS ADJACENT THE LOT BOUNDARY, A 100mm PVC IRRIGATION CONDUIT SHOULD BE PROVIDED IN ADDITION TO THE 100mm PVC STORMWATER KERB OUTLET. THE IRRIGATION CONDUIT SHOULD EXTEND 300mm EACH SIDE OF THE FOOTPATH AND BE CAPPED AT EACH END. PLACE CONDUIT 1m OFFSET FROM WATER METER. IF WATER METER IS ADJACENT DRIVEWAY, PLACE CONDUIT 1m OFFSET FROM DRIVEWAY EDGE (CONFIRM ON SITE).
2. FOR ALL IRRIGATION CONDUITS CROSSING ROADS, PROVIDE 2 x Ø100mm PVC PIPE, EXTENDING 1m PAST THE BACK OF KERB ON BOTH SIDES, CAP EACH END AND PROVIDE DRAWCORDS TO THE SURFACE.
3. PROVIDE Ø100mm PVC IRRIGATION CONDUITS UNDER FUTURE DRIVEWAY LOCATIONS WHERE SHOWN EXTENDING 300mm EACH SIDE OF FUTURE DRIVEWAY, CAP EACH END.
4. PROVIDE 150 HIGH BARRIER KERB AND GUTTER ON ALL KERB RETURNS AT INTERSECTIONS AND EXTEND MINIMUM 6.0m PAST TANGENT POINTS.
5. TRAFFIC CONTROL DETAILS AND RETROREFLECTIVE RAISED PAVEMENT MARKERS INSTALLED IN ACCORDANCE WITH AUSTRALIAN STANDARD 'AS 1742 MANUAL OF TRAFFIC CONTROL DEVICES' AS MODIFIED BY DIT'S CODE OF TECHNICAL REQUIREMENTS, AND THE DIT 'PAVEMENT MARKING MANUAL'.
6. REFER TO SHEETS 080 TO 083 FOR STREET SIGN LOCATIONS. FOR SIGN INSTALLATION DETAILS REFER TO 'DIT MASTER SPECIFICATION, PART RD-LM-C4 SIGN INSTALLATION' & CITY OF PLAYFORD REQUIREMENTS.
7. ANY BATTERS REQUIRED DURING CONSTRUCTION TO BE GRADED BACK TO EXISTING AT 1 IN 5 MAXIMUM.
8. ALL EARTHWORKS FILL WITHIN ALLOTMENTS TO BE TO LEVEL 1 AS PER SPECIFICATION REQUIREMENTS

THIS DRAWING IS TO BE VIEWED IN COLOUR AS SOME FEATURES / SYMBOLS ARE DIFFERENTIATED BY COLOUR. DRAWING NOT TO BE RELIED ON IF PRINTED IN GREYSCALE.

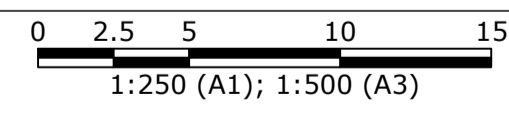

SHEET SIZE
A1

COORDS: MGA94 ZONE 54
DATUM: ALL LEVELS TO A.H.D.
SCALE: 1:250
SURVEYED: ALEXANDER SYMONDS
SURVEY DATE: 19.10.2020
APPROVED / PROJECT LEADER
S.CONDINA

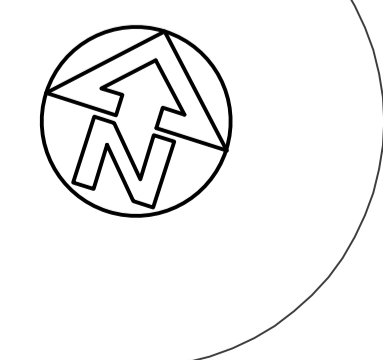

PUBLIC UTILITIES:
THE SERVICES SHOWN ARE DERIVED FROM PLANS OBTAINED FROM THE RELEVANT SERVICE AUTHORITIES. IT IS THE RESPONSIBILITY OF THE CONTRACTOR TO ARRANGE WITH THE RELEVANT SERVICE AUTHORITIES FOR CONFIRMATION OF SERVICES AND THEIR LOCATION BEFORE EXCAVATION WORK COMMENCES.



FOR CONSTRUCTION

ASTRAD PTY LTD
VIRGINIA GROVE - STAGE 18
D/N: 292/D003/20 - SHEEDY ROAD VIRGINIA
GENERAL CONSTRUCTION PLAN - SHEET 2

FILENAME: 220419_04_GENERAL_CONSTRUCTION.DWG	PROJECT NUMBER 220419	DRAWING NUMBER 021	REVISION 1
---	---------------------------------	------------------------------	----------------------

FOR CONTINUATION REFER SHEET 021

FOR CONTINUATION REFER SHEET 020

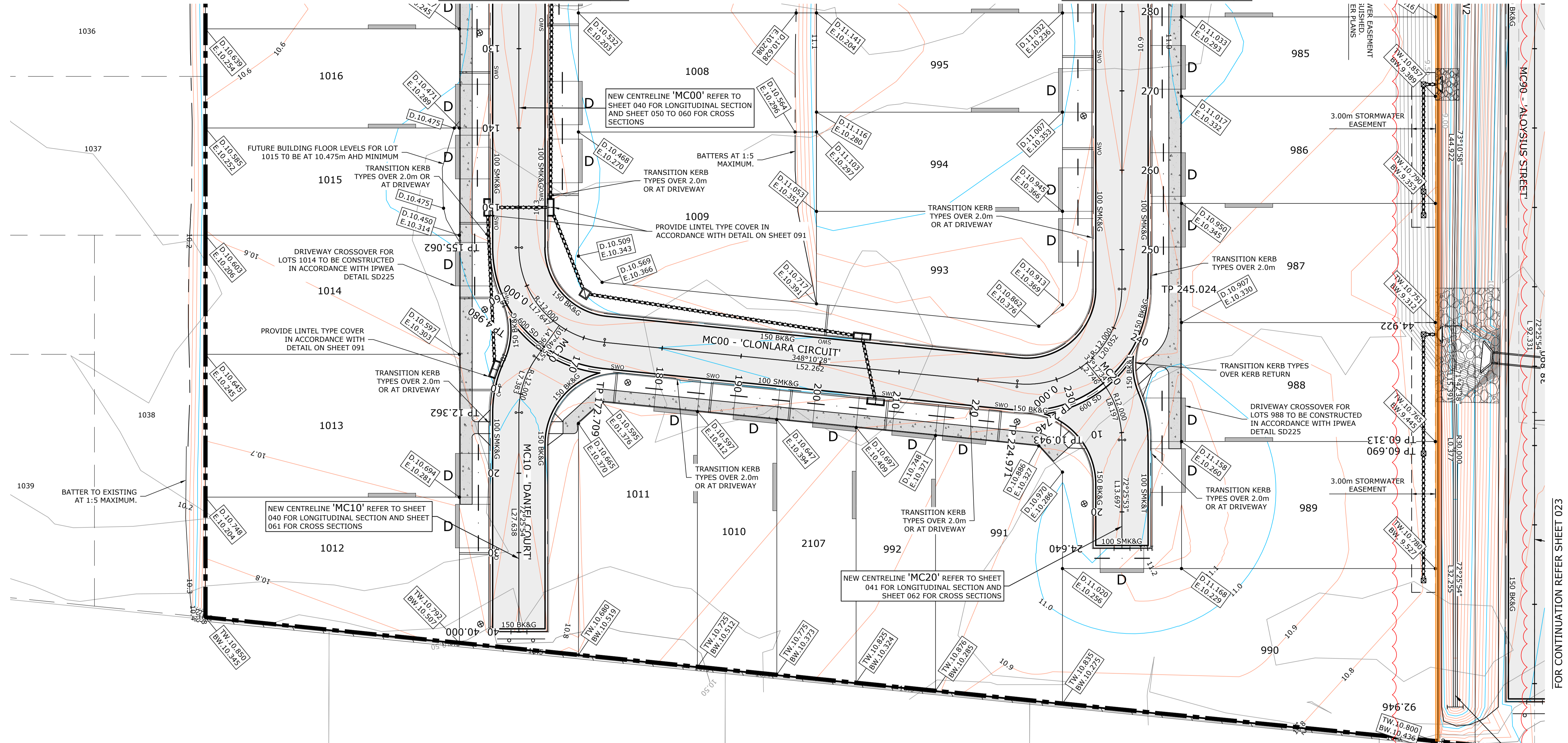

LEGEND:

- 150 HIGH BARRIER KERB & GUTTER (REFER SHEET 091 FOR DETAILS)
- 150 BARRIER KERB & TRAY (REFER SHEET 091 FOR DETAILS)
- 100 HIGH SEMI-MOUNTABLE KERB & GUTTER (REFER SHEET 091 FOR DETAILS)
- 100 HIGH SEMI-MOUNTABLE KERB & TRAY (REFER SHEET 091 FOR DETAILS)
- 600 WIDE SPOON DRAIN (REFER SHEET 091 FOR DETAILS)
- 190 WIDE CONCEALED EDGE BEAM (REFER SHEET 091 FOR DETAILS)
- DESIGN SURFACE LEVEL
- EXISTING SURFACE LEVEL
- TOP OF RETAINING WALL
- BOTTOM OF RETAINING WALL
- CONCRETE KERB RAMP (REFER IPWEA DETAIL SD125 & SD130)
- PROPOSED SIDE ENTRY PIT (SEP) (REFER SHEETS 070 TO 073)
- PROPOSED JUNCTION BOX (JB) (REFER SHEETS 070 TO 073)
- PROPOSED GRATED INLET PIT (GIP) (REFER SHEETS 070 TO 073)
- PROPOSED HEADWALL (HW) (REFER SHEETS 070 TO 073)
- PROPOSED STORM WATER KERB OUTLET (REFER SHEET 091 FOR DETAILS)
- PROPOSED LIGHT POLE (REFER SAPN DRAWINGS)
- DENOTES FUTURE DRIVEWAY LOCATION (BY OTHERS)
- DENOTES ALLOWABLE BOUNDARY BUILD (BY FUTURE OWNER)
- EXISTING STORMWATER DRAIN
- PROPOSED STORMWATER DRAIN (REFER SHEETS 070 TO 073)
- NEW ROAD PAVEMENT (REFER SHEET 084 FOR DETAILS)
- BLOCK PAVED THRESHOLD (REFER SHEET 084 FOR DETAILS)
- NEW 1.5m WIDE FOOTPATH (REFER SHEET 084 FOR DETAILS)
- FINISHED SURFACE MINOR CONTOURS (0.1m INTERVAL)
- FINISHED SURFACE MAJOR CONTOURS (0.5m INTERVAL)
- EXISTING SURFACE MINOR CONTOURS (0.1m INTERVAL)
- EXISTING SURFACE MAJOR CONTOURS (0.5m INTERVAL)
- PROPOSED STAGE BOUNDARY
- PROPOSED Ø100mm IRRIGATION CONDUIT. REFER TO NOTES
- PROPOSED CONCRETE SLEEPER RETAINING WALL. REFER SHEET 092 FOR DETAILS
- PROPOSED GABION WALL (BY OTHERS)

NOTES:

1. FOR EACH LOT WHERE THE FOOTPATH IS ADJACENT THE LOT BOUNDARY, A 100mm PVC IRRIGATION CONDUIT SHOULD BE PROVIDED IN ADDITION TO THE 100mm PVC STORMWATER KERB OUTLET. THE IRRIGATION CONDUIT SHOULD EXTEND 300mm EACH SIDE OF THE FOOTPATH AND BE CAPPED AT EACH END. PLACE CONDUIT 1m OFFSET FROM WATER METER. IF WATER METER IS ADJACENT DRIVEWAY, PLACE CONDUIT 1m OFFSET FROM DRIVEWAY EDGE (CONFIRM ON SITE).
2. FOR ALL IRRIGATION CONDUITS CROSSING ROADS, PROVIDE 2 x Ø100mm PVC PIPE, EXTENDING 1m PAST THE BACK OF KERB ON BOTH SIDES, CAP EACH END AND PROVIDE DRAWCORDS TO THE SURFACE.
3. PROVIDE Ø100mm PVC IRRIGATION CONDUITS UNDER FUTURE DRIVEWAY LOCATIONS WHERE SHOWN EXTENDING 300mm EACH SIDE OF FUTURE DRIVEWAY, CAP EACH END.
4. PROVIDE 150 HIGH BARRIER KERB AND GUTTER ON ALL KERB RETURNS AT INTERSECTIONS AND EXTEND MINIMUM 6.0m PAST TANGENT POINTS.
5. TRAFFIC CONTROL DETAILS AND RETROREFLECTIVE RAISED PAVEMENT MARKERS INSTALLED IN ACCORDANCE WITH AUSTRALIAN STANDARD 'AS 1742 MANUAL OF TRAFFIC CONTROL DEVICES' AS MODIFIED BY DIT'S CODE OF TECHNICAL REQUIREMENTS, AND THE DIT 'PAVEMENT MARKING MANUAL'.
6. REFER TO SHEETS 080 TO 083 FOR STREET SIGN LOCATIONS. FOR SIGN INSTALLATION DETAILS REFER TO 'DIT MASTER SPECIFICATION, PART RD-LM-C4 SIGN INSTALLATION' & CITY OF PLAYFORD REQUIREMENTS.
7. ANY BATTERS REQUIRED DURING CONSTRUCTION TO BE GRADED BACK TO EXISTING AT 1 IN 5 MAXIMUM.
8. ALL EARTHWORKS FILL WITHIN ALLOTMENTS TO BE TO LEVEL 1 AS PER SPECIFICATION REQUIREMENTS

ON HOLD PENDING FINAL SOLUTION AND APPROVAL IN COORDINATION WITH COUNCIL

THIS DRAWING IS TO BE VIEWED IN COLOUR AS SOME FEATURES / SYMBOLS ARE DIFFERENTIATED BY COLOUR. DRAWING NOT TO BE RELIED ON IF PRINTED IN GREYSCALE.

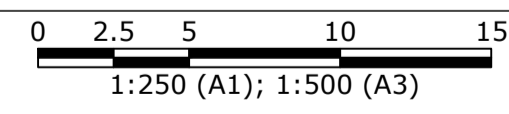

SHEET SIZE
A1

COORDS: MGA94 ZONE 54
 DATUM: ALL LEVELS TO A.H.D.
 SCALE: 1:250
 SURVEYED: ALEXANDER SYMONDS
 SURVEY DATE: 19.10.2020
 APPROVED / PROJECT LEADER
 S.CONDINA

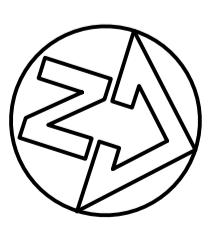

PUBLIC UTILITIES:
 THE SERVICES SHOWN ARE DERIVED FROM PLANS OBTAINED FROM THE RELEVANT SERVICE AUTHORITIES. IT IS THE RESPONSIBILITY OF THE CONTRACTOR TO ARRANGE WITH THE RELEVANT SERVICE AUTHORITIES FOR CONFIRMATION OF SERVICES AND THEIR LOCATION BEFORE EXCAVATION WORK COMMENCES.



FOR CONSTRUCTION
 ASTRAD PTY LTD
 VIRGINIA GROVE - STAGE 18
 D/N: 292/D003/20 - SHEEDY ROAD VIRGINIA
 GENERAL CONSTRUCTION PLAN - SHEET 3

FILENAME:	PROJECT NUMBER	DRAWING NUMBER	REVISION
220419_04_GENERAL_CONSTRUCTION.DWG	220419	022	1

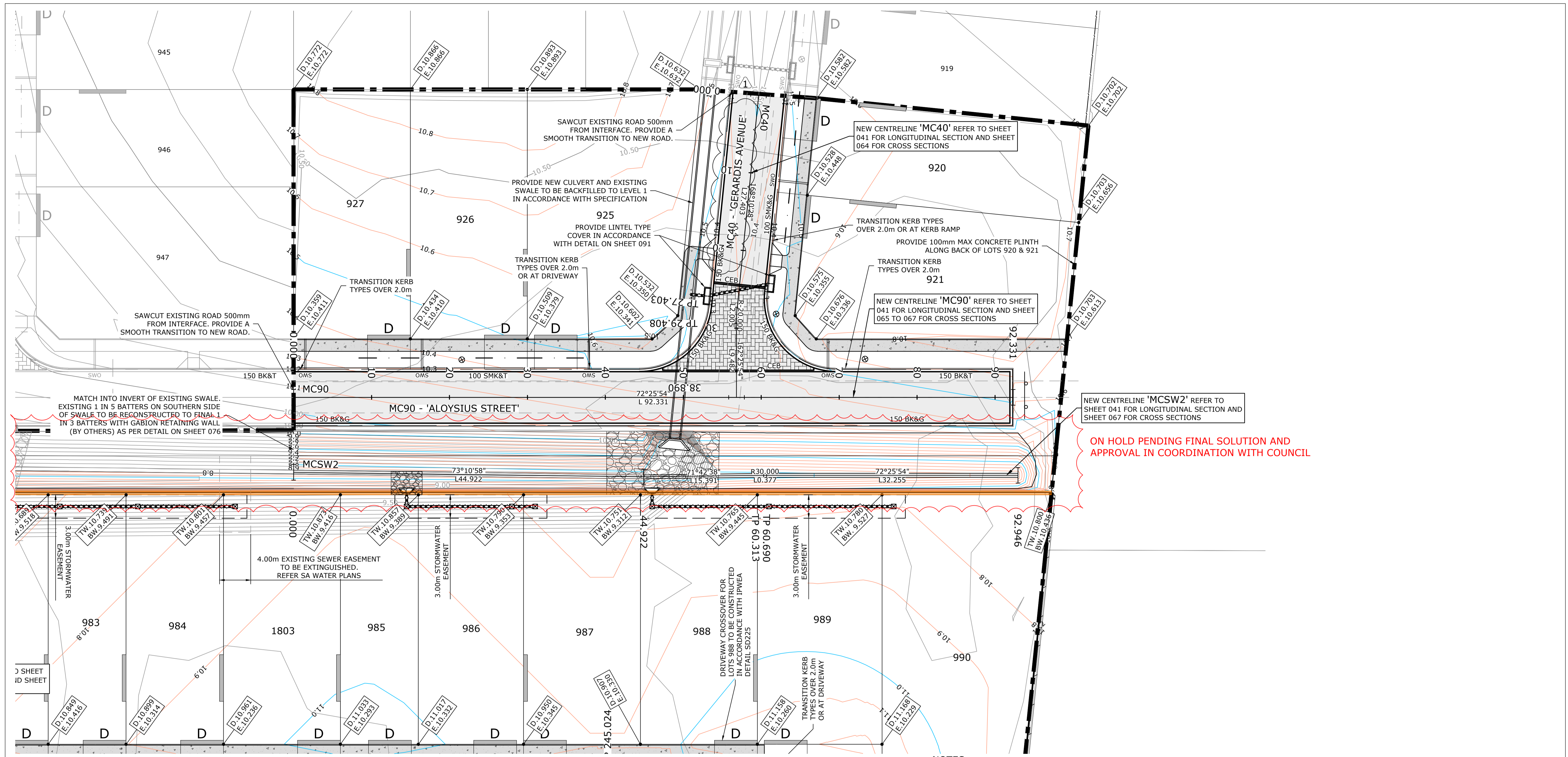

FOR CONTINUATION REFER SHEET 020

FOR CONTINUATION REFER SHEET 022

NOTES:

- FOR EACH LOT WHERE THE FOOTPATH IS ADJACENT THE LOT BOUNDARY, A 100mm PVC IRRIGATION CONDUIT SHOULD BE PROVIDED IN ADDITION TO THE 100mm PVC STORMWATER KERB OUTLET. THE IRRIGATION CONDUIT SHOULD EXTEND 300mm EACH SIDE OF THE FOOTPATH AND BE CAPPED AT EACH END. PLACE CONDUIT 1m OFFSET FROM WATER METER. IF WATER METER IS ADJACENT DRIVEWAY, PLACE CONDUIT 1m OFFSET FROM DRIVEWAY EDGE (CONFIRM ON SITE).
- FOR ALL IRRIGATION CONDUITS CROSSING ROADS, PROVIDE 2 x Ø100mm PVC PIPE, EXTENDING 1m PAST THE BACK OF KERB ON BOTH SIDES, CAP EACH END AND PROVIDE DRAWCORDS TO THE SURFACE.
- PROVIDE Ø100mm PVC IRRIGATION CONDUITS UNDER FUTURE DRIVEWAY LOCATIONS WHERE SHOWN EXTENDING 300mm EACH SIDE OF FUTURE DRIVEWAY, CAP EACH END.
- PROVIDE 150 HIGH BARRIER KERB AND GUTTER ON ALL KERB RETURNS AT INTERSECTIONS AND EXTEND MINIMUM 6.0m PAST TANGENT POINTS.
- TRAFFIC CONTROL DETAILS AND RETROREFLECTIVE RAISED PAVEMENT MARKERS INSTALLED IN ACCORDANCE WITH AUSTRALIAN STANDARD 'AS 1742 MANUAL OF TRAFFIC CONTROL DEVICES' AS MODIFIED BY DIT'S CODE OF TECHNICAL REQUIREMENTS, AND THE DIT 'PAVEMENT MARKING MANUAL'.
- REFER TO SHEETS 080 TO 083 FOR STREET SIGN LOCATIONS. FOR SIGN INSTALLATION DETAILS REFER TO 'DIT MASTER SPECIFICATION, PART RD-LM-C4 SIGN INSTALLATION' & CITY OF PLYMOUTH REQUIREMENTS.
- ANY BATTERS REQUIRED DURING CONSTRUCTION TO BE GRADED BACK TO EXISTING AT 1 IN 5 MAXIMUM.
- ALL EARTHWORKS FILL WITHIN ALLOTMENTS TO BE TO LEVEL 1 AS PER SPECIFICATION REQUIREMENTS

LEGEND:

- 150 BK&G 150 HIGH BARRIER KERB & GUTTER (REFER SHEET 091 FOR DETAILS)
- 150 BK&T 150 BARRIER KERB & TRAY (REFER SHEET 091 FOR DETAILS)
- 100 SMK&G 100 HIGH SEMI-MOUNTABLE KERB & GUTTER (REFER SHEET 091 FOR DETAILS)
- 100 SMK&T 100 HIGH SEMI-MOUNTABLE KERB & TRAY (REFER SHEET 091 FOR DETAILS)
- 600 SD 600 WIDE SPOON DRAIN (REFER SHEET 091 FOR DETAILS)
- CEB 190 WIDE CONCEALED EDGE BEAM (REFER SHEET 091 FOR DETAILS)
- D.XX.XX DESIGN SURFACE LEVEL
- E.XX.XX EXISTING SURFACE LEVEL
- TW.XX.XX TOP OF RETAINING WALL
- BW.XX.XX BOTTOM OF RETAINING WALL
- CONCRETE KERB RAMP (REFER IPWEA DETAIL SD125 & SD130)
- PROPOSED SIDE ENTRY PIT (SEP) (REFER SHEETS 070 TO 073)
- PROPOSED JUNCTION BOX (JB) (REFER SHEETS 070 TO 073)
- PROPOSED GRATED INLET PIT (GIP) (REFER SHEETS 070 TO 073)
- PROPOSED HEADWALL (HW) (REFER SHEETS 070 TO 073)
- PROPOSED STORM WATER KERB OUTLET (REFER SHEET 091 FOR DETAILS)
- PROPOSED LIGHT POLE (REFER SAPN DRAWINGS)
- D DENOTES FUTURE DRIVEWAY LOCATION (BY OTHERS)
- DENOTES ALLOWABLE BOUNDARY BUILD (BY FUTURE OWNER)
- EXISTING STORMWATER DRAIN
- PROPOSED STORMWATER DRAIN (REFER SHEETS 070 TO 073)
- NEW ROAD PAVEMENT (REFER SHEET 084 FOR DETAILS)
- BLOCK PAVED THRESHOLD (REFER SHEET 084 FOR DETAILS)
- NEW 1.5m WIDE FOOTPATH (REFER SHEET 084 FOR DETAILS)
- FINISHED SURFACE MINOR CONTOURS (0.1m INTERVAL)
- FINISHED SURFACE MAJOR CONTOURS (0.5m INTERVAL)
- EXISTING SURFACE MINOR CONTOURS (0.1m INTERVAL)
- EXISTING SURFACE MAJOR CONTOURS (0.5m INTERVAL)
- PROPOSED STAGE BOUNDARY
- PROPOSED Ø100mm IRRIGATION CONDUIT. REFER TO NOTES
- PROPOSED CONCRETE SLEEPER RETAINING WALL. REFER SHEET 092 FOR DETAILS
- PROPOSED GABION WALL (BY OTHERS)

THIS DRAWING IS TO BE VIEWED IN COLOUR AS SOME FEATURES / SYMBOLS ARE DIFFERENTIATED BY COLOUR. DRAWING NOT TO BE RELIED ON IF PRINTED IN GREYSCALE.

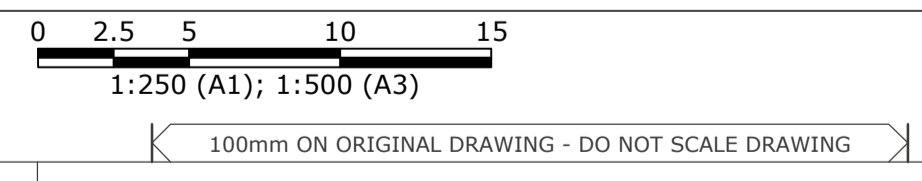

SHEET SIZE
A1

COORDS: MGA94 ZONE 54		DATUM: ALL LEVELS TO A.H.D.	
SCALE: 1:250		SURVEYED: ALEXANDER SYMONDS	
		SURVEY DATE: 19.10.2020	
1 STREET NAME CHANGE - LEO AVENUE TO GERARDIS AVENUE		18.07.23	IH IH
0 ISSUED FOR CONSTRUCTION		20.03.23	RIH RIH
REV	AMENDMENT / REASON FOR ISSUE	DATE	DES. DWN.
		S.CONDINA	

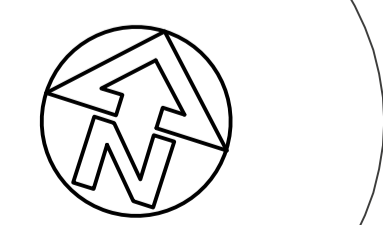

PUBLIC UTILITIES:
THE SERVICES SHOWN ARE DERIVED FROM PLANS OBTAINED FROM THE RELEVANT SERVICE AUTHORITIES. IT IS THE RESPONSIBILITY OF THE CONTRACTOR TO ARRANGE WITH THE RELEVANT SERVICE AUTHORITIES FOR CONFIRMATION OF SERVICES AND THEIR LOCATION BEFORE EXCAVATION WORK COMMENCES.



FOR CONSTRUCTION
ASTRAD PTY LTD
VIRGINIA GROVE - STAGE 18
D/N: 292/D003/20 - SHEEDY ROAD VIRGINIA
GENERAL CONSTRUCTION PLAN - SHEET 4

FILENAME:	PROJECT NUMBER	DRAWING NUMBER	REVISION
220419_04_GENERAL_CONSTRUCTION.DWG	220419	023	1