

FOR CONTINUATION REFER SHEET 021

LEGEND:

- PROPOSED STAGE BOUNDARY
- PROPOSED WATER MAIN (REFER SA WATER DRAWINGS)
- PROPOSED CST (REFER SAPN DRAWINGS)
- PROPOSED SEWER MAIN (REFER SA WATER DRAWINGS)
- PROPOSED STORMWATER DRAIN (REFER SHEETS 070 TO 074)
- PROPOSED Ø100mm IRRIGATION CONDUIT. REFER GENERAL CONSTRUCTION DRAWINGS FOR IRRIGATION NOTES
- PROPOSED FOOTPATH
- PROPOSED STORM WATER KERB OUTLET
- PROPOSED WATER CONNECTION (REFER SA WATER DRAWINGS)
- PROPOSED POTABLE WATER FITTINGS (REFER SA WATER DRAWINGS)
- PROPOSED SAPN PILLAR/UNDERGROUND PIT (REFER SAPN DRAWINGS)
- PROPOSED SAPN LIGHT POLE (REFER SAPN DRAWINGS)
- PROPOSED SEWER MAN HOLE (REFER SA WATER DRAWINGS)
- PROPOSED MAINTENANCE SHAFT (REFER SA WATER DRAWINGS)
- PROPOSED SEWER I.O. (REFER SA WATER DRAWINGS)
- PROPOSED SEWER CONNECTION (REFER SA WATER DRAWINGS)
- PROPOSED SIDE ENTRY PIT (SEP) (REFER SHEETS 070 TO 074)
- PROPOSED JUNCTION BOX (JB) (REFER SHEETS 070 TO 074)
- PROPOSED REAR OF ALLOTMENT DRAIN (HD) (REFER SHEETS 070 TO 074)
- PROPOSED HEADWALL (HW) (REFER SHEETS 070 TO 074)
- DENOTES FUTURE DRIVEWAY LOCATION (BY OTHERS)
- DENOTES ALLOWABLE BOUNDARY BUILD (BY FUTURE OWNER)
- EXISTING WATER MAIN
- EXISTING CST
- EXISTING SEWER MAIN
- EXISTING STORMWATER DRAIN

0 2.5 5 10 15
1:250 (A1); 1:500 (A3)

100mm ON ORIGINAL DRAWING - DO NOT SCALE DRAWING

SHEET SIZE
A1

COORDS: MGA94 ZONE 54
DATUM: ALL LEVELS TO A.H.D.
SCALE: 1:250
SURVEYED: ALEXANDER SYMONDS
SURVEY DATE: 19.10.2020
APPROVED / PROJECT LEADER
TIM THIEL

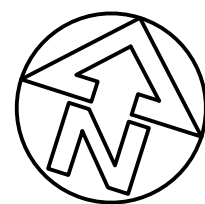

PUBLIC UTILITIES:

THE SERVICES SHOWN ARE DERIVED FROM PLANS OBTAINED FROM THE RELEVANT SERVICE AUTHORITIES. IT IS THE RESPONSIBILITY OF THE CONTRACTOR TO ARRANGE WITH THE RELEVANT SERVICE AUTHORITIES FOR CONFIRMATION OF SERVICES AND THEIR LOCATION BEFORE EXCAVATION WORK COMMENCES.

THIS DRAWING IS TO BE VIEWED IN COLOUR AS SOME FEATURES / SYMBOLS ARE DIFFERENTIATED BY COLOUR. DRAWING NOT TO BE RELIED ON IF PRINTED IN GREYSKALE.

FOR CONSTRUCTION

tonkin
tonkin.com.au

ASTRAD PTY LTD
VIRGINIA GROVE - STAGE 11
D/N: 292/D016/21 - SHEEDY ROAD VIRGINIA
MASTER SERVICES PLAN - SHEET 1

FILENAME:	PROJECT NUMBER	DRAWING NUMBER	REVISION
202508_03_SERVICES.DWG	202508	020	0

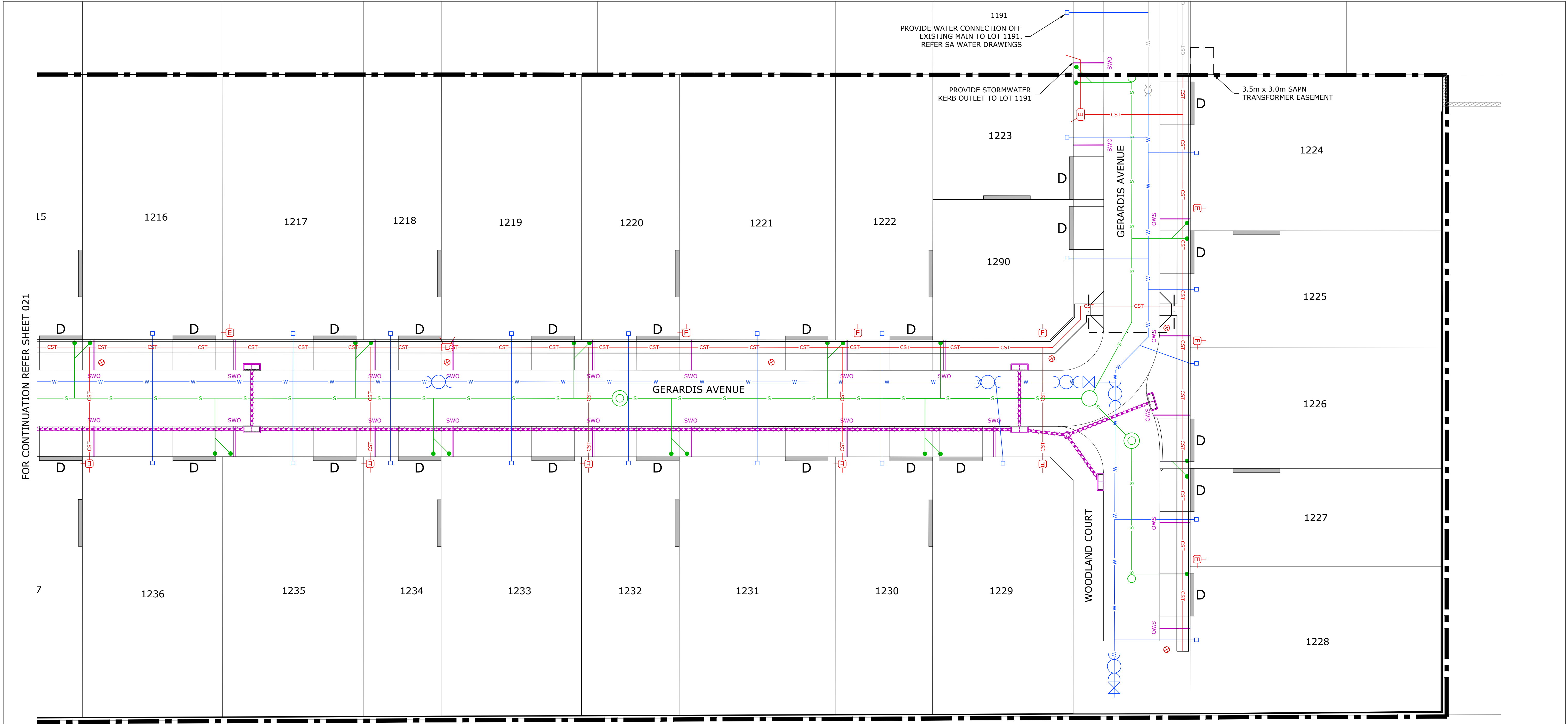

LEGEND:

- PROPOSED STAGE BOUNDARY
- PROPOSED WATER MAIN (REFER SA WATER DRAWINGS)
- PROPOSED CST (REFER SAPN DRAWINGS)
- PROPOSED SEWER MAIN (REFER SA WATER DRAWINGS)
- PROPOSED STORMWATER DRAIN (REFER SHEETS 070 TO 074)
- PROPOSED Ø100mm IRRIGATION CONDUIT. REFER GENERAL CONSTRUCTION DRAWINGS FOR IRRIGATION NOTES
- PROPOSED FOOTPATH
- PROPOSED STORM WATER KERB OUTLET
- PROPOSED WATER CONNECTION (REFER SA WATER DRAWINGS)
- PROPOSED POTABLE WATER FITTINGS (REFER SA WATER DRAWINGS)
- PROPOSED SAPN PILLAR/UNDERGROUND PIT (REFER SAPN DRAWINGS)
- PROPOSED SAPN LIGHT POLE (REFER SAPN DRAWINGS)
- PROPOSED SEWER MAN HOLE (REFER SA WATER DRAWINGS)
- PROPOSED MAINTENANCE SHAFT (REFER SA WATER DRAWINGS)
- PROPOSED SEWER I.O. (REFER SA WATER DRAWINGS)
- PROPOSED SEWER CONNECTION (REFER SA WATER DRAWINGS)
- PROPOSED SIDE ENTRY PIT (SEP) (REFER SHEETS 070 TO 074)
- PROPOSED JUNCTION BOX (JB) (REFER SHEETS 070 TO 074)
- PROPOSED REAR OF ALLOTMENT DRAIN (HD) (REFER SHEETS 070 TO 074)
- PROPOSED HEADWALL (HW) (REFER SHEETS 070 TO 074)
- DENOTES FUTURE DRIVEWAY LOCATION (BY OTHERS)
- DENOTES ALLOWABLE BOUNDARY BUILD (BY FUTURE OWNER)
- EXISTING WATER MAIN
- EXISTING CST
- EXISTING SEWER MAIN
- EXISTING STORMWATER DRAIN

0 2.5 5 10 15
1:250 (A1); 1:500 (A3)

100mm ON ORIGINAL DRAWING - DO NOT SCALE DRAWING

SHEET SIZE
A1

COORDS: MGA94 ZONE 54
DATUM: ALL LEVELS TO A.H.D.
SCALE: 1:250
SURVEYED: ALEXANDER SYMONDS
SURVEY DATE: 19.10.2020
APPROVED / PROJECT LEADER
TIM THIEL

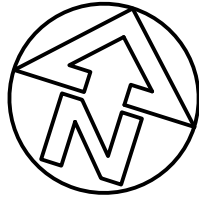

PUBLIC UTILITIES:
THE SERVICES SHOWN ARE DERIVED FROM PLANS OBTAINED FROM THE RELEVANT SERVICE AUTHORITIES. IT IS THE RESPONSIBILITY OF THE CONTRACTOR TO ARRANGE WITH THE RELEVANT SERVICE AUTHORITIES FOR CONFIRMATION OF SERVICES AND THEIR LOCATION BEFORE EXCAVATION WORK COMMENCES.

THIS DRAWING IS TO BE VIEWED IN COLOUR AS SOME FEATURES / SYMBOLS ARE DIFFERENTIATED BY COLOUR. DRAWING NOT TO BE RELIED ON IF PRINTED IN GREYSKALE.

FOR CONSTRUCTION

tonkin
tonkin.com.au

ASTRAD PTY LTD
VIRGINIA GROVE - STAGE 11
D/N: 292/D016/21 - SHEEDY ROAD VIRGINIA
MASTER SERVICES PLAN - SHEET 3

FILENAME: 202508_03_SERVICES.DWG PROJECT NUMBER 202508 DRAWING NUMBER 022 REVISION 0

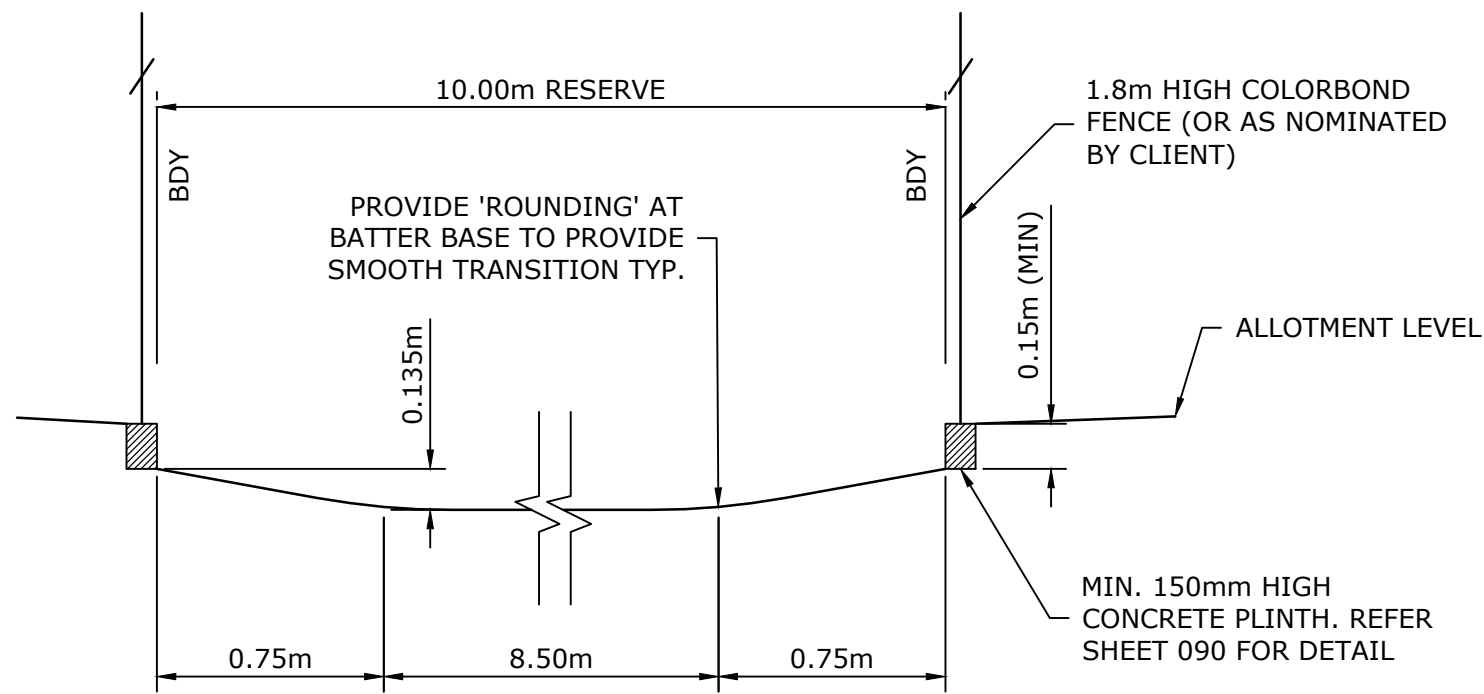
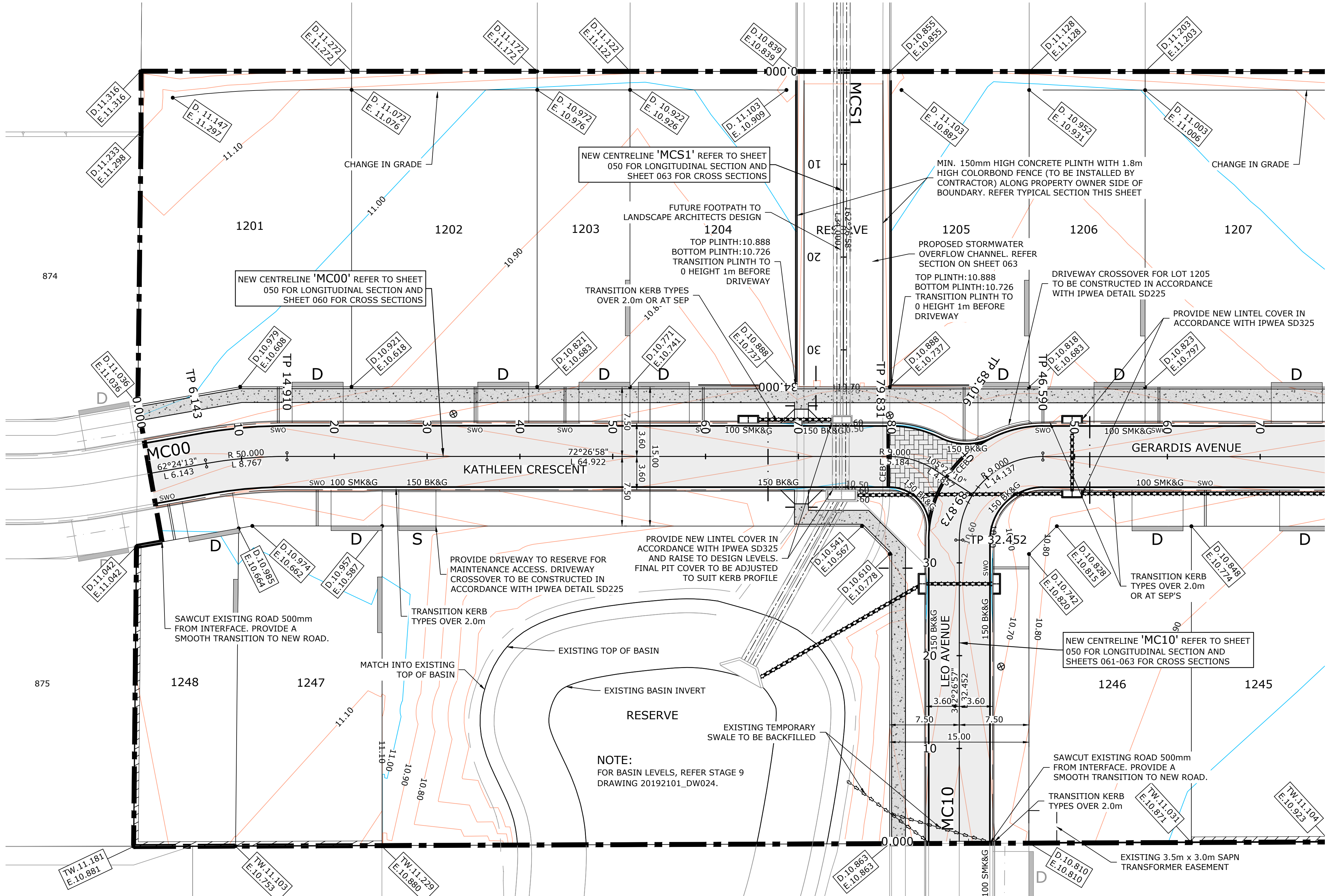

TYPICAL OVERFLOW CHANNEL SECTION
NOT TO SCALE

LEGEND:

- PROPOSED STAGE BOUNDARY
- NEW ROAD PAVEMENT (REFER SHEET 083 FOR DETAILS)
- BLOCK PAVED THRESHOLD (REFER SHEET 083 FOR DETAILS)
- NEW 1.5m WIDE FOOTPATH (REFER SHEET 083 FOR DETAILS)
- 150 BK&G
- 100 SMK&G
- 600 SD
- CEB
- PROPOSED STORMWATER DRAIN (REFER SHEETS 070 TO 074)
- CONCRETE KERB RAMP (REFER IPWEA DETAIL SD125 & SD130)
- PROPOSED SIDE ENTRY PIT (SEP) (REFER SHEET 074)
- PROPOSED JUNCTION BOX (JB) (REFER SHEET 074)
- PROPOSED REAR OF ALLOTMENT DRAIN (HD) (REFER SHEETS 070 TO 074)
- PROPOSED HEADWALL (HW) (REFER SHEETS 070 TO 074)
- PROPOSED STORM WATER KERB OUTLET (REFER SHEET 090 FOR DETAILS)
- PROPOSED LIGHT POLE (REFER SAPN DRAWINGS)
- PROPOSED Ø100mm IRRIGATION CONDUIT. REFER TO NOTES
- FINISHED SURFACE MINOR CONTOURS (0.1m INTERVAL)
- FINISHED SURFACE MAJOR CONTOURS (0.5m INTERVAL)
- D
- PROPOSED 1.8m HIGH FENCE (BY FENCING CONTRACTOR)
- PROPOSED RETAINING WALL. REFER SHEET 090 FOR DETAILS
- EXISTING STORMWATER DRAIN
- DESIGN SURFACE LEVEL
- EXISTING SURFACE LEVEL
- TOP OF RETAINING WALL

NOTES:

- FOR EACH LOT WHERE THE FOOTPATH IS ADJACENT THE LOT BOUNDARY, A 100mm PVC IRRIGATION CONDUIT SHOULD BE PROVIDED IN ADDITION TO THE 100mm PVC STORMWATER KERB OUTLET. THE IRRIGATION CONDUIT SHOULD EXTEND 300mm EACH SIDE OF THE FOOTPATH AND BE CAPPED AT EACH END. PLACE CONDUIT 1m OFFSET FROM WATER METER. IF WATER METER IS ADJACENT DRIVEWAY, PLACE CONDUIT 1m OFFSET FROM DRIVEWAY EDGE (CONFIRM ON SITE).
- FOR ALL IRRIGATION CONDUITS CROSSING ROADS, PROVIDE 2 x Ø100mm PVC PIPE, EXTENDING 1m PAST THE BACK OF KERB ON BOTH SIDES, CAP EACH END AND PROVIDE DRAWCORDS TO THE SURFACE.
- PROVIDE 150 HIGH BARRIER KERB AND GUTTER ON ALL KERB RETURNS AT INTERSECTIONS.
- TRAFFIC CONTROL DETAILS AND RETROREFLECTIVE RAISED PAVEMENT MARKERS INSTALLED IN ACCORDANCE WITH AUSTRALIAN STANDARD 'AS 1742 MANUAL OF TRAFFIC CONTROL DEVICES' AS MODIFIED BY DIT'S CODE OF TECHNICAL REQUIREMENTS, AND THE DIT 'PAVEMENT MARKING MANUAL'.
- REFER TO SHEETS 080 TO 082 FOR STREET SIGN LOCATIONS. FOR SIGN INSTALLATION DETAILS REFER TO 'DIT MASTER SPECIFICATION, PART RD-LM-C4 SIGN INSTALLATION' & CITY OF PLAYFORD REQUIREMENTS.
- ANY BATTERS REQUIRED DURING CONSTRUCTION TO BE GRADED BACK TO EXISTING AT 1 IN 5 MINIMUM.

PUBLIC UTILITIES:

THE SERVICES SHOWN ARE DERIVED FROM PLANS OBTAINED FROM THE RELEVANT SERVICE AUTHORITIES. IT IS THE RESPONSIBILITY OF THE CONTRACTOR TO ARRANGE WITH THE RELEVANT SERVICE AUTHORITIES FOR CONFIRMATION OF SERVICES AND THEIR LOCATION BEFORE EXCAVATION WORK COMMENCES.

THIS DRAWING IS TO BE VIEWED IN COLOUR AS SOME FEATURES / SYMBOLS ARE DIFFERENTIATED BY COLOUR. DRAWING NOT TO BE RELIED ON IF PRINTED IN GREYSCALE.

FOR CONSTRUCTION

ASTRAD PTY LTD
VIRGINIA GROVE - STAGE 11
D/N: 292/D016/21 - SHEEDY ROAD VIRGINIA
GENERAL CONSTRUCTION PLAN - SHEET 1



tonkin.com.au

0 ISSUED FOR CONSTRUCTION		04.11.21	RIH	RIH
REV AMENDMENT / REASON FOR ISSUE		DATE	DES.	DWN.
APPROVED / PROJECT LEADER		TIM THIEL		

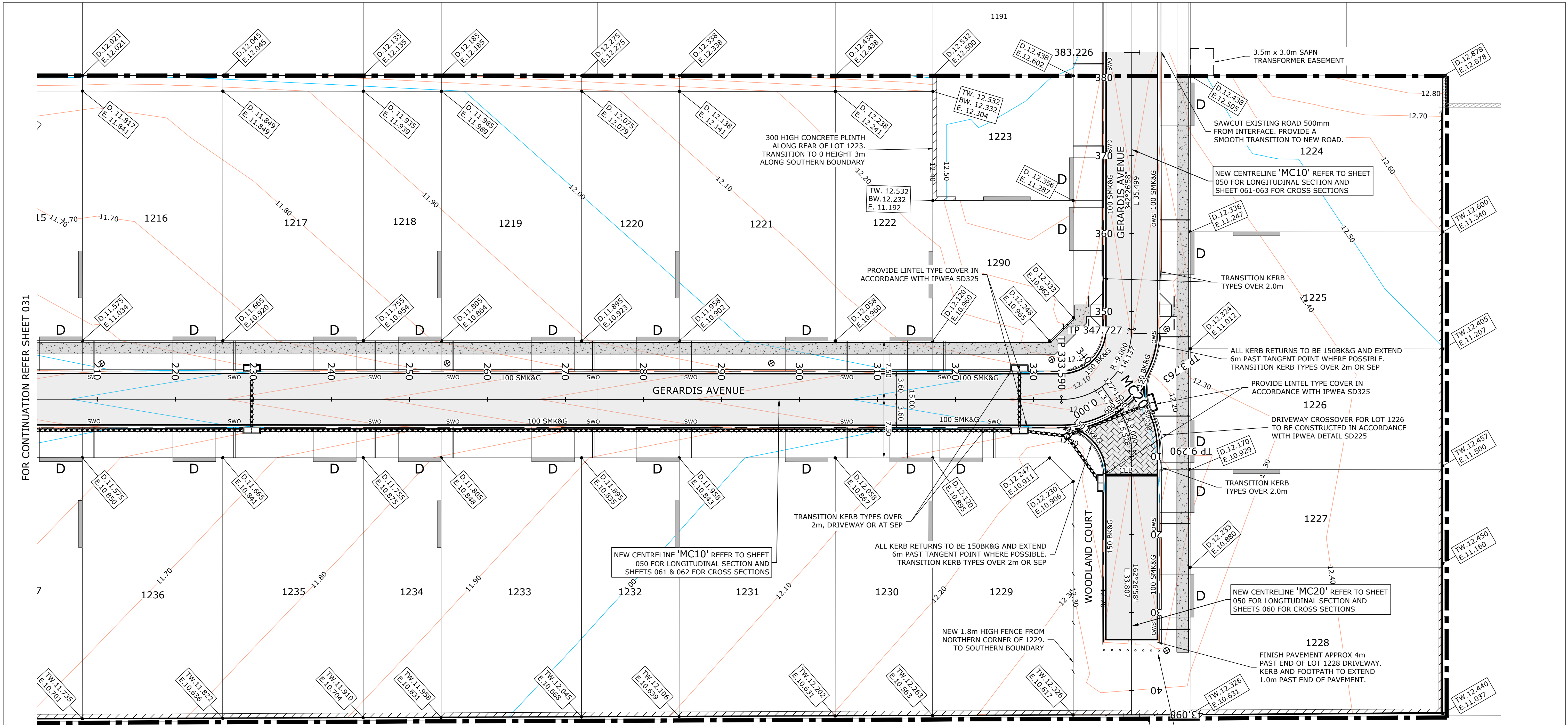

LEGEND:

- PROPOSED STAGE BOUNDARY
- NEW ROAD PAVEMENT (REFER SHEET 083 FOR DETAILS)
- BLOCK PAVED THRESHOLD (REFER SHEET 083 FOR DETAILS)
- NEW 1.5m WIDE FOOTPATH (REFER SHEET 083 FOR DETAILS)
- 150 BK&G
- 100 SMK&G
- 600 SD
- CEB
- PROPOSED STORMWATER DRAIN (REFER SHEETS 070 TO 074)
- CONCRETE KERB RAMP (REFER IPWEA DETAIL SD125 & SD130)
- PROPOSED SIDE ENTRY PIT (SEP) (REFER SHEET 074)
- PROPOSED JUNCTION BOX (JB) (REFER SHEET 074)
- PROPOSED REAR OF ALLOTMENT DRAIN (HD) (REFER SHEETS 070 TO 074)
- PROPOSED HEADWALL (HW) (REFER SHEETS 070 TO 074)
- PROPOSED STORM WATER KERB OUTLET (REFER SHEET 090 FOR DETAILS)
- PROPOSED LIGHT POLE (REFER SAPN DRAWINGS)
- PROPOSED Ø100mm IRRIGATION CONDUIT. REFER TO NOTES
- FINISHED SURFACE MINOR CONTOURS (0.1m INTERVAL)
- FINISHED SURFACE MAJOR CONTOURS (0.5m INTERVAL)
- DENOTES FUTURE DRIVEWAY LOCATION (BY OTHERS)
- DENOTES ALLOWABLE BOUNDARY BUILD (BY FUTURE OWNER)
- PROPOSED 1.8m HIGH FENCE. (BY FENCING CONTRACTOR)
- PROPOSED RETAINING WALL. REFER SHEET 090 FOR DETAILS
- EXISTING STORMWATER DRAIN
- DESIGN SURFACE LEVEL
- EXISTING SURFACE LEVEL
- TOP OF RETAINING WALL

NOTES:

- FOR EACH LOT WHERE THE FOOTPATH IS ADJACENT THE LOT BOUNDARY, A 100mm PVC IRRIGATION CONDUIT SHOULD BE PROVIDED IN ADDITION TO THE 100mm PVC STORMWATER KERB OUTLET. THE IRRIGATION CONDUIT SHOULD EXTEND 300mm EACH SIDE OF THE FOOTPATH AND BE CAPPED AT EACH END. PLACE CONDUIT 1m OFFSET FROM WATER METER. IF WATER METER IS ADJACENT DRIVEWAY, PLACE CONDUIT 1m OFFSET FROM DRIVEWAY EDGE (CONFIRM ON SITE).
- FOR ALL IRRIGATION CONDUITS CROSSING ROADS, PROVIDE 2 x Ø100mm PVC PIPE, EXTENDING 1m PAST THE BACK OF KERB ON BOTH SIDES, CAP EACH END AND PROVIDE DRAWCORDS TO THE SURFACE.
- PROVIDE 150 HIGH BARRIER KERB AND GUTTER ON ALL KERB RETURNS AT INTERSECTIONS.
- TRAFFIC CONTROL DETAILS AND RETROREFLECTIVE RAISED PAVEMENT MARKERS INSTALLED IN ACCORDANCE WITH AUSTRALIAN STANDARD 'AS 1742 MANUAL OF TRAFFIC CONTROL DEVICES' AS MODIFIED BY DIT'S CODE OF TECHNICAL REQUIREMENTS, AND THE DIT 'PAVEMENT MARKING MANUAL'.
- REFER TO SHEETS 080 TO 082 FOR STREET SIGN LOCATIONS. FOR SIGN INSTALLATION DETAILS REFER TO DIT MASTER SPECIFICATION, PART RD-LM-C4 SIGN INSTALLATION' & CITY OF PLAYFORD REQUIREMENTS.
- ANY BATTERS REQUIRED DURING CONSTRUCTION TO BE GRADED BACK TO EXISTING AT 1 IN 5 MINIMUM.

PUBLIC UTILITIES:

THE SERVICES SHOWN ARE DERIVED FROM PLANS OBTAINED FROM THE RELEVANT SERVICE AUTHORITIES. IT IS THE RESPONSIBILITY OF THE CONTRACTOR TO ARRANGE WITH THE RELEVANT SERVICE AUTHORITIES FOR CONFIRMATION OF SERVICES AND THEIR LOCATION BEFORE EXCAVATION WORK COMMENCES.

THIS DRAWING IS TO BE VIEWED IN COLOUR AS SOME FEATURES / SYMBOLS ARE DIFFERENTIATED BY COLOUR. DRAWING NOT TO BE RELIED ON IF PRINTED IN GREYSKALE.

FOR CONSTRUCTION

ASTRAD PTY LTD
VIRGINIA GROVE - STAGE 11
D/N: 292/D016/21 - SHEEDY ROAD VIRGINIA
GENERAL CONSTRUCTION PLAN - SHEET 3



tonkin.com.au

FILENAME:	PROJECT NUMBER	DRAWING NUMBER	REVISION
202508_04_GENERAL_CONSTRUCTION.DWG	202508	032	0

REV	ISSUED FOR CONSTRUCTION	04.11.21	RIH	RIH
AMENDMENT / REASON FOR ISSUE	DATE	DES.	DWN.	

COORDS: MGA94 ZONE 54
DATUM: ALL LEVELS TO A.H.D.
SCALE: 1:250
SURVEYED: ALEXANDER SYMONDS
SURVEY DATE: 19.10.2020
APPROVED / PROJECT LEADER
TIM THIEL

