

- NOTES:**
1. PROVIDE IRRIGATION CONDUIT FOR EACH LOT WHERE FOOTPATH OCCURS. 90mm PVC STORMWATER PIPE EXTENDING 300mm EACH SIDE OF FOOTPATH. CAP EACH END. PLACE CONDUIT 1m OFF-SET FROM WATER METER. IF WATER METER IS ADJACENT DRIVEWAY, PLACE CONDUIT 1m OFF-SET FROM DRIVEWAY EDGE (CONFIRM ON SITE).
  2. FOR ALL IRRIGATION CONDUITS CROSSING ROADS, PROVIDE 2 x Ø90mm PVC PIPE, EXTENDING 1m PAST THE BACK OF KERB ON BOTH SIDES, CAP EACH END.
  3. PROVIDE Ø90mm PVC IRRIGATION CONDUITS UNDER FUTURE DRIVEWAY LOCATIONS WHERE SHOWN EXTENDING 300mm EACH SIDE OF FUTURE DRIVEWAY, CAP EACH END.
  4. SUB-BASE & KERBING TO CONTINUE 2.0m PAST STAGE BOUNDARY (TYPICAL).
  5. PROVIDE 150 HIGH BARRIER KERB AND GUTTER ON ALL KERB RETURNS AT INTERSECTIONS.
  6. REFER TO SHEETS 121 TO 123 FOR LAYOUT, TRAFFIC CONTROL DETAILS AND RETROREFLECTIVE RAISED PAVEMENT MARKERS INSTALLED IN ACCORDANCE WITH AUSTRALIAN STANDARD 'AS 1742 MANUAL OF TRAFFIC CONTROL DEVICES' AS MODIFIED BY DPTI'S CODE OF TECHNICAL REQUIREMENTS, AND THE DPTI 'PAVEMENT MARKING MANUAL'.
  7. REFER TO SHEETS 121 TO 123 FOR STREET SIGN LOCATIONS. FOR SIGN INSTALLATION DETAILS REFER TO DPTI MASTER SPECIFICATION, PART R49 - INSTALLATION OF SIGNS & CITY OF PLAYFORD REQUIREMENTS.

REFER TO SHEET 106 FOR GENERAL CONSTRUCTION PLAN LEGEND.

THIS DRAWING IS TO BE VIEWED IN COLOUR AS SOME FEATURES / SYMBOLS ARE DIFFERENTIATED BY COLOUR. DRAWING NOT TO BE RELIED ON IF PRINTED IN GREYSCALE.

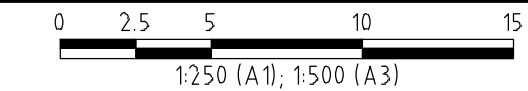

**PUBLIC UTILITIES:**  
THE SERVICES SHOWN ARE DERIVED FROM PLANS OBTAINED FROM THE RELEVANT SERVICE AUTHORITIES. IT IS THE RESPONSIBILITY OF THE CONTRACTOR TO ARRANGE WITH THE RELEVANT SERVICE AUTHORITIES FOR CONFIRMATION OF SERVICES AND THEIR LOCATION BEFORE EXCAVATION WORK COMMENCES.

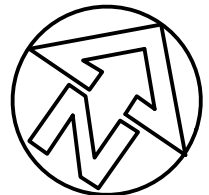

**Tonkin**  
CONSULTING  
www.tonkin.com.au

**ISSUED FOR CONSTRUCTION**

<b>SHEET SIZE</b> A1	<b>ASTRAD PTY. LTD.</b>
<b>SCALE:</b> 1 : 250 @ A1	<b>VIRGINIA GROVE DEVELOPMENT - STAGE 6</b>
<b>ORIGINAL SURVEY BY</b> ALEXANDER & SYMONDS	<b>D/N: 292/D071/14 - SHEEDY ROAD, VIRGINIA</b>
<b>SURVEY DATE:</b> 23.01.2015	<b>GENERAL CONSTRUCTION PLAN - SHEET 2 OF 3</b>
<b>COORDS &amp; DATUM</b> COORDS TO (MCA94 ZONE54) ALL LEVELS TO A.I.D.	<b>FILENAME:</b> 20171619_ST6_04_GENERAL_CONSTRUCTION.DWG
	<b>JOB NUMBER</b> 20171619
	<b>SHEET NUMBER</b> 107
	<b>REVISION</b> 1

1	ISSUE FOR CONSTRUCTION	18.06.18	PMD	PMD	BEM	ACM	AJF
REV	AMENDMENT / REASON FOR ISSUE	DATE	DES.	DWN.	DWGCHK.	VERIFIED	APPROVED

100mm ON ORIGINAL DRAWING - DO NOT SCALE DRAWING



FOR CONTINUATION REFER SHEET 107

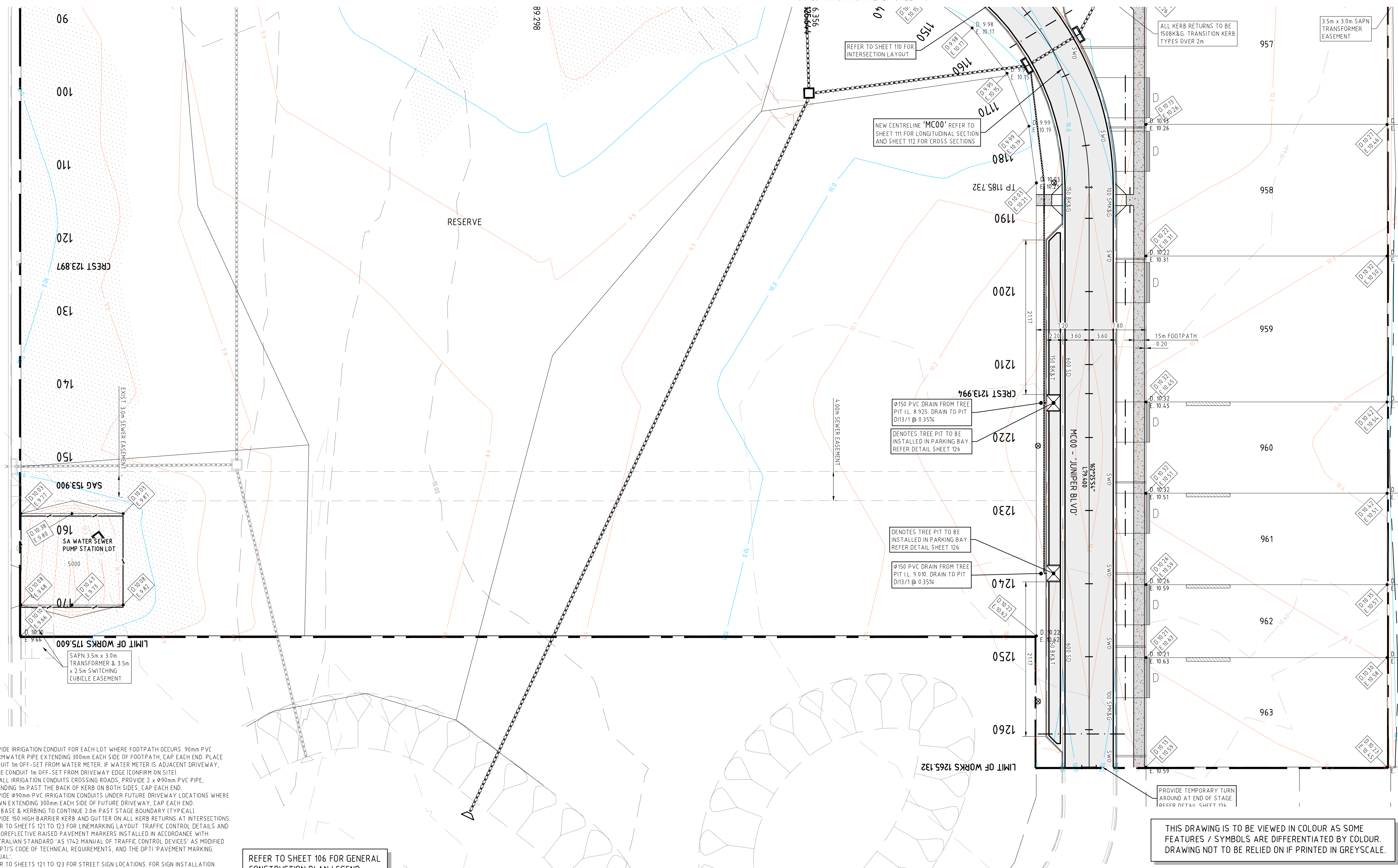

REFER TO SHEET 106 FOR GENERAL CONSTRUCTION PLAN LEGEND.

**NOTES:**

1. PROVIDE IRRIGATION CONDUIT FOR EACH LOT WHERE FOOTPATH OCCURS. 90mm PVC STORMWATER PIPE EXTENDING 300mm EACH SIDE OF FOOTPATH, CAP EACH END. PLACE CONDUIT 1m OFF-SET FROM WATER METER. IF WATER METER IS ADJACENT DRIVEWAY, PLACE CONDUIT 1m OFF-SET FROM DRIVEWAY EDGE (CONFIRM ON SITE).
2. FOR ALL IRRIGATION CONDUITS CROSSING ROADS, PROVIDE 2 x 90mm PVC PIPE, EXTENDING 1m PAST THE BACK OF KERB ON BOTH SIDES, CAP EACH END.
3. PROVIDE 90mm PVC IRRIGATION CONDUITS UNDER FUTURE DRIVEWAY LOCATIONS WHERE SHOWN EXTENDING 300mm EACH SIDE OF FUTURE DRIVEWAY, CAP EACH END.
4. SUB-BASE & KERBING TO CONTINUE 2.0m PAST STAGE BOUNDARY (TYPICAL).
5. PROVIDE 150 HIGH BARRIER KERB AND GUTTER ON ALL KERB RETURNS AT INTERSECTIONS. REFER TO SHEETS 121 TO 123 FOR LAYOUT. TRAFFIC CONTROL DETAILS AND RETROREFLECTIVE RAISED PAVEMENT MARKERS INSTALLED IN ACCORDANCE WITH AUSTRALIAN STANDARD AS 1742 MANUAL OF TRAFFIC CONTROL DEVICES AS MODIFIED BY DPTI'S CODE OF TECHNICAL REQUIREMENTS, AND THE DPTI PAVEMENT MARKING MANUAL.
6. REFER TO SHEETS 121 TO 123 FOR STREET SIGN LOCATIONS. FOR SIGN INSTALLATION DETAILS REFER TO DPTI MASTER SPECIFICATION, PART R49 - INSTALLATION OF SIGNS & CITY OF PLAYFORD REQUIREMENTS.

REV	ISSUE FOR CONSTRUCTION	DATE	DES.	DWN.	DWGCHK.	VERIFIED	APPROVED
1	ISSUE FOR CONSTRUCTION	18.06.18	PMD	PMD	BEM	ACM	AJF
	AMENDMENT / REASON FOR ISSUE						

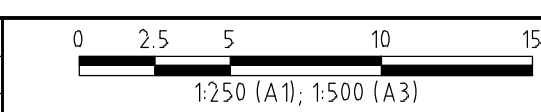

**PUBLIC UTILITIES:**  
THE SERVICES SHOWN ARE DERIVED FROM PLANS OBTAINED FROM THE RELEVANT SERVICE AUTHORITIES. IT IS THE RESPONSIBILITY OF THE CONTRACTOR TO ARRANGE WITH THE RELEVANT SERVICE AUTHORITIES FOR CONFIRMATION OF SERVICES AND THEIR LOCATION BEFORE EXCAVATION WORK COMMENCES.

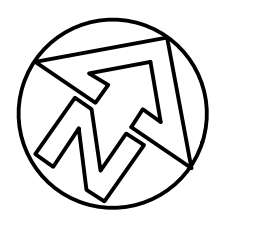

**Tonkin**  
CONSULTING  
www.tonkin.com.au

SHEET SIZE **A1**  
SCALE: 1 : 250 @ A1  
ORIGINAL SURVEY BY  
ALEXANDER & SYMONDS  
SURVEY DATE: 23.01.2015  
COORDS & DATUM  
COORDS TO (MCA94 ZONE54)  
ALL LEVELS TO A.H.D.

ISSUED FOR CONSTRUCTION			
ASTRAD PTY. LTD.			
VIRGINIA GROVE DEVELOPMENT - STAGE 6			
D/N: 292/D071/14 - SHEEDY ROAD, VIRGINIA			
GENERAL CONSTRUCTION PLAN - SHEET 3 OF 3			
FILENAME:	JOB NUMBER	SHEET NUMBER	REVISION
20171619_ST6_04_GENERAL_CONSTRUCTION.DWG	20171619	108	1