

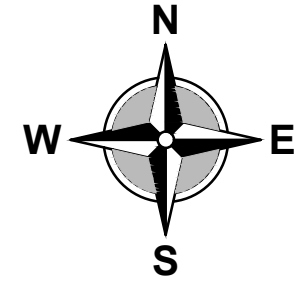

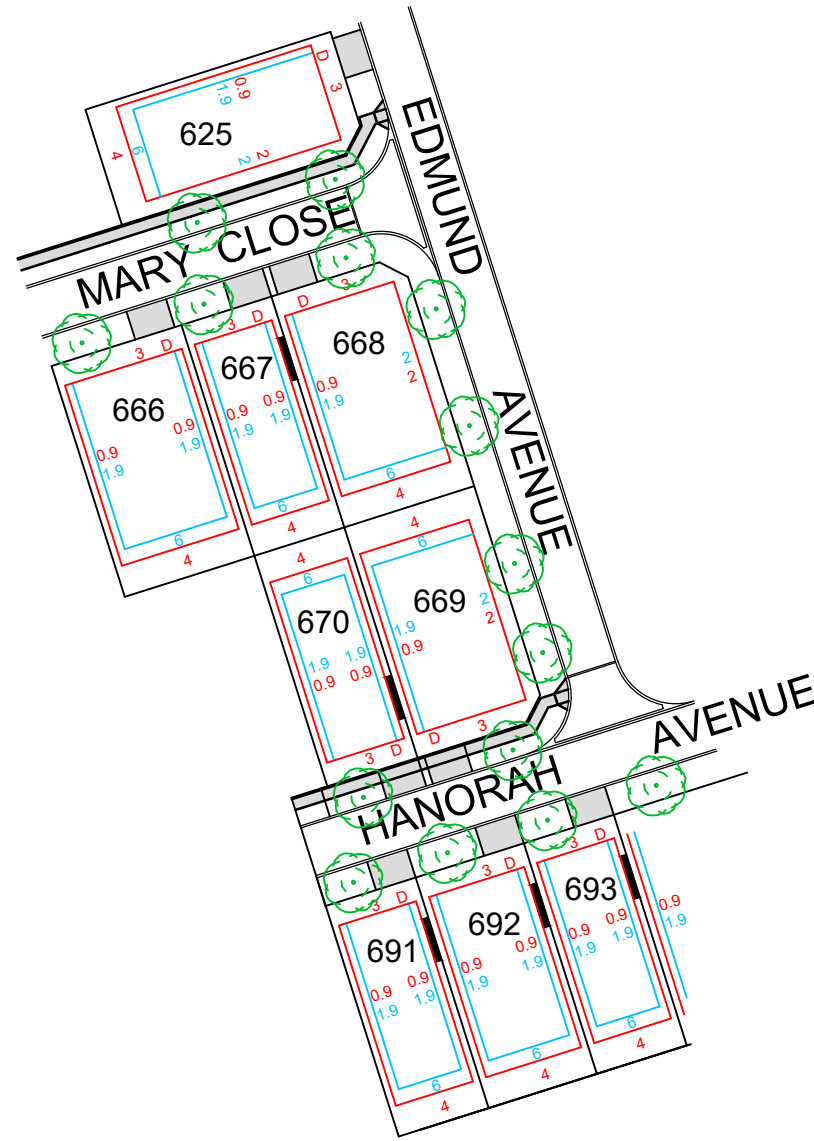

VIRGINIA GROVE



REV B 05.11.2019



 A minimum of one street tree will be provided in the front verge of each allotment. Location may vary. For secondary frontages 1-2 trees may be planted, depending on service locations.

 Denotes garage can be built on boundary.

Preferred driveway locations are indicated on the plan. Alternative driveway locations are subject to developer approval and associated service relocation costs are to be borne by the applicant.

D Denotes double driveway location.

S Denotes single driveway location

 Single Storey Setback
(distance from boundary or tie line shown)

 Two Storey Setback
(distance from boundary or tie line shown)

Garage/ Carport minimum setback 5.5m

Road pavements show are indicative only

Envelopes are indicative showing minimum set backs only at the time of preparation. Council and Development Plan requirements must also be adhered to.

A004314BEP STAGE 5 -3 SOUTH REV B.DWG

